



Computer Enclosure Replacement Instructions

Be sure to follow the instructions in this sheet carefully. Failure to follow these instructions could result in damage to your equipment and may void your warranty.

Replacing your computer enclosure requires three basic steps:

- Turn off the computer.
- Remove the computer core from the enclosure.
- Replace the computer core in the new enclosure.

Note: A video version of the replacement instructions is available at <http://www.info.apple.com/installparts>

Tools Required

No tools are required for this procedure.

Electrostatic Discharge (ESD)

Static electricity, a normal and natural phenomenon, builds up on your body as you walk around. You experience an electrostatic discharge (ESD) when you touch an object and feel a spark. ESD can cause damage to the internal components of your computer.

Removing the Computer Core From the Enclosure

Warning: Always turn off your computer before opening it to avoid damaging its internal components.

- 1 Place your computer on a clean, flat surface.
- 2 Shut down your computer by opening the Special menu and choosing Shut Down. Then wait five minutes for the computer's internal components to cool down.
- 3 Unplug all cables from the computer except the power cord.

Note: If you have never plugged in your computer, connect the computer's power cord and plug it in.

- 4 Turn your computer upside down on a soft, clean cloth.
- 5 Touch the bare metal at the port access covers on the back of the computer.

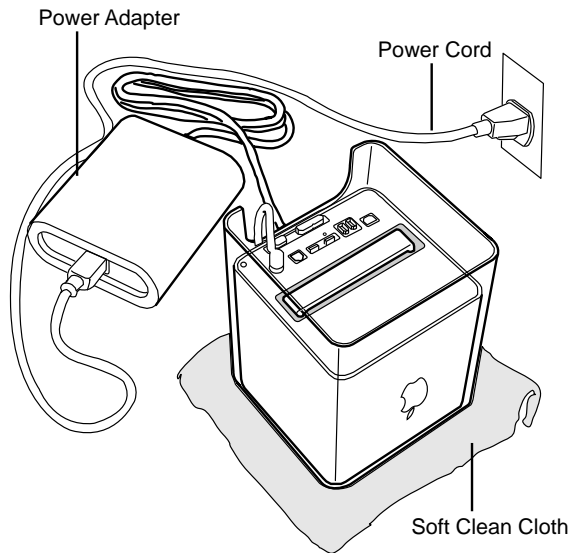

Important: To avoid electrostatic discharge, always ground yourself by touching the port access covers before you touch any parts or install any components inside the computer. To avoid static electricity building back up in your body, do not walk around the room until you have completed the installation and closed the computer.

- 6 Unplug the power cord.

- 7 Push down on the latch to release it.

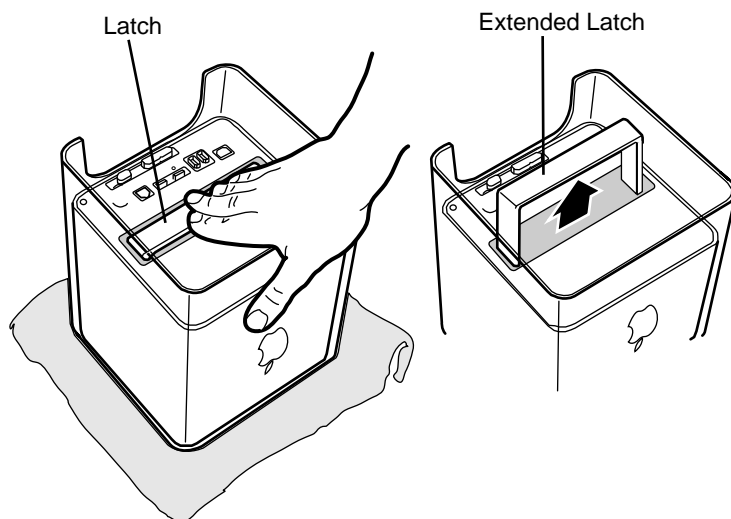

Allow the latch to extend completely.

- 8 Gently pull the core from the computer enclosure and place the core on a soft cloth.

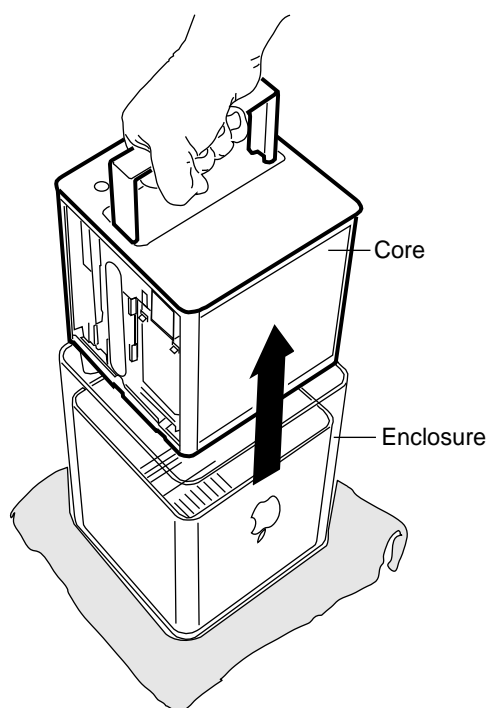

Replacing the Computer Core in the New Enclosure

- 1 Holding the core by the latch, insert the core into the new enclosure.

Note: The core fits into the enclosure only one way. Position the core so the ports are toward the back of the enclosure.

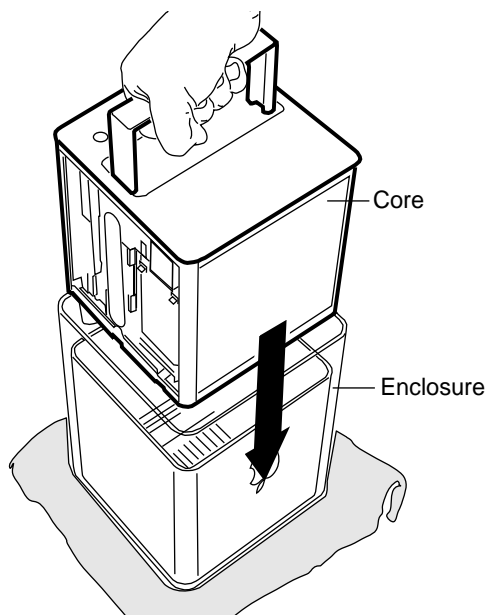

- 2 With a flat hand, press down on the latch until it locks into place. Firmly press the core to ensure it is fully secured within the enclosure.

Important: Do not lift or carry your computer by the core latch. The enclosure could fall off the core and be damaged.

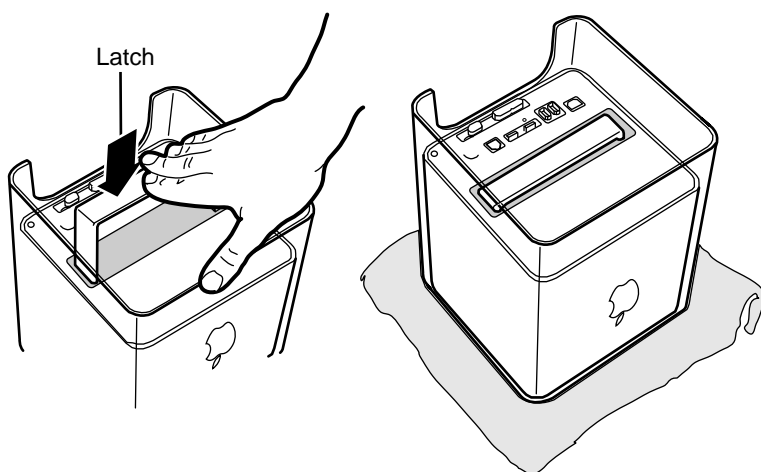

- 3 Turn your computer upright and reconnect all cables.
- 4 Restart your computer.

Warning: Never turn on your computer unless all of its internal and external parts are in place and it is closed. Operating the computer when it is open or missing parts can damage your computer or cause injury.

🍏 Apple Computer, Inc.

© 2000 Apple Computer, Inc. All rights reserved.

Under the copyright laws, this document may not be copied, in whole or in part, without the written consent of Apple.

The Apple logo is a trademark of Apple Computer, Inc., registered in the U.S. and other countries. Use of the “keyboard” Apple logo (Option-Shift-K) for commercial purposes without the prior written consent of Apple may constitute trademark infringement and unfair competition in violation of federal and state laws.

Every effort has been made to ensure that the information in this document is accurate. Apple is not responsible for printing or clerical errors.

Apple Computer, Inc.
1 Infinite Loop
Cupertino, CA 95014-2084
408-996-1010
<http://www.apple.com>

Apple, the Apple logo, Mac, Macintosh, and the Mac logo are trademarks of Apple Computer, Inc., registered in the U.S. and other countries.

Power Mac is a trademark of Apple Computer, Inc.

Battery

Replacement Instructions

Be sure to follow these instructions carefully. Failure to follow these instructions could result in damage to your equipment and may void your warranty.

Replacing the battery requires five basic steps:

- Turn off the computer.
- Remove the computer core from the enclosure.
- Remove the installed battery.
- Install the replacement battery.
- Replace the computer core in the enclosure.

Note: A video version of the replacement instructions is available at <http://www.info.apple.com/installparts>

Tools Required

No tools are required for this procedure.

Electrostatic Discharge (ESD)

Static electricity, a normal and natural phenomenon, builds up on your body as you walk around. You experience an electrostatic discharge (ESD) when you touch an object and feel a spark. ESD can cause damage to the internal components of your computer. Avoid walking around while performing this procedure, and follow the instructions carefully when you are asked to discharge static electricity.

Removing the Computer Core From the Enclosure

Warning: Always turn off your computer before opening it to avoid damaging its internal components.

- 1 Place your computer on a clean, flat surface.
- 2 Shut down your computer by opening the Special menu and choosing Shut Down. Then wait five minutes for the computer's internal components to cool down.
- 3 Unplug all cables from the computer except the power cord.

Note: If you have never plugged in your computer, connect the computer's power cord and plug it in.

- 4 Turn your computer upside down on a soft, clean cloth.
- 5 Touch the bare metal at the port access covers on the back of the computer.

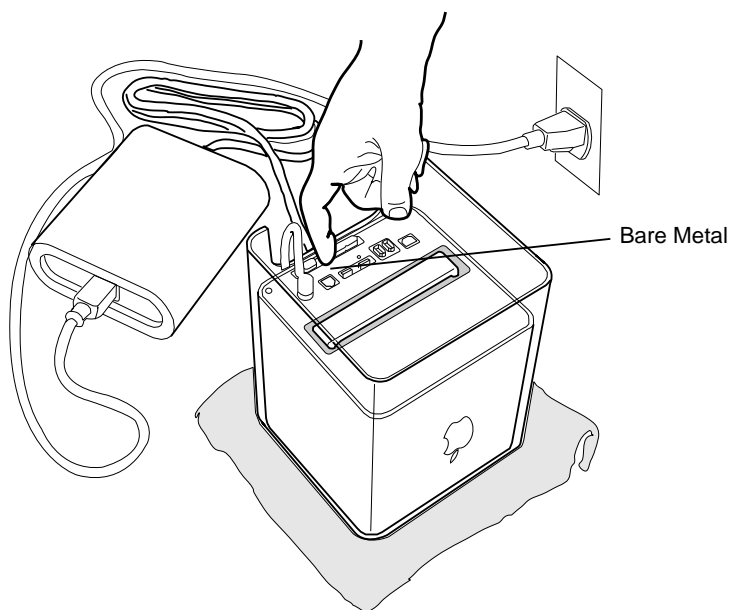

Important: To avoid electrostatic discharge, always ground yourself by touching the port access covers before you touch any parts or install any components inside the computer. To avoid static electricity building back up in your body, do not walk around the room until you have completed the installation and closed the computer.

- 6 Unplug the power cord.

- 7 Push down on the latch to release it.

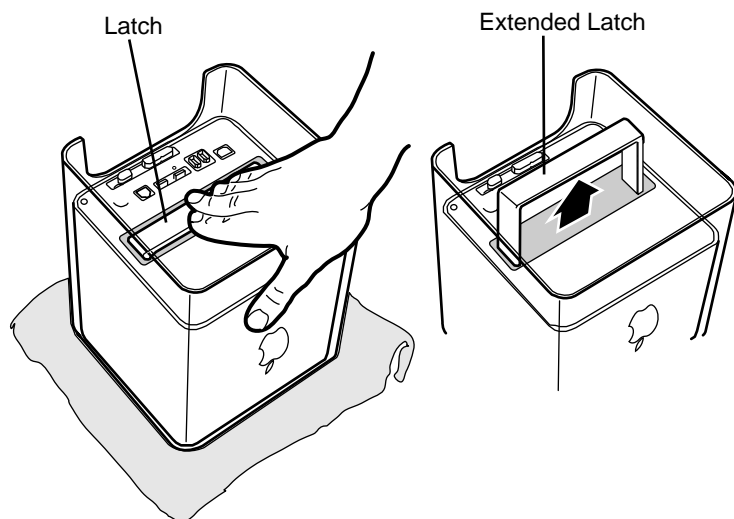

Allow the latch to extend completely.

- 8 Gently pull the core from the computer enclosure and place it on a soft cloth.

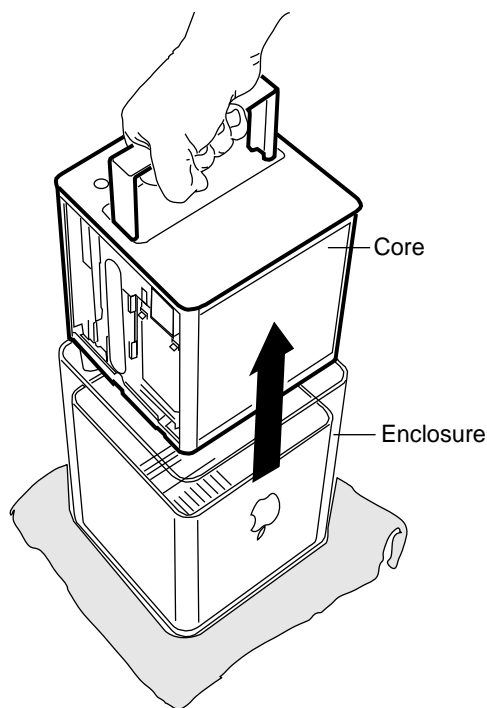

Replacing the Battery

- 1 Note the orientation of the installed battery's positive (+) end. (Positive and negative signs are also marked on the battery holder.)
- 2 At the battery's positive end, place your finger between the battery and the holder. Gently pry the battery out of the holder and out of the computer.

Warning: Batteries contain chemicals, some of which may be harmful to the environment. Please dispose of used batteries according to your local environmental laws and guidelines. Do not return used batteries to Apple.

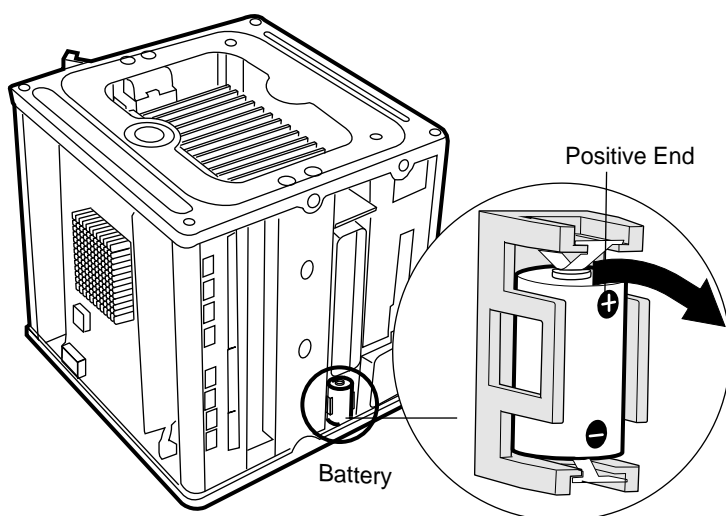

- 3 Insert the new battery into the holder, making sure the battery's positive and negative signs align with those on the holder.

Warning: Installing the battery incorrectly may cause an explosion. Be sure the battery's positive and negative poles are correctly oriented in the holder. Use only the battery supplied with this kit.

Replacing the Computer Core in the Enclosure

- 1 Holding the core by the latch, insert the core into the computer.

Note: The core fits into the enclosure only one way. Position the core so the ports are toward the back of the enclosure.

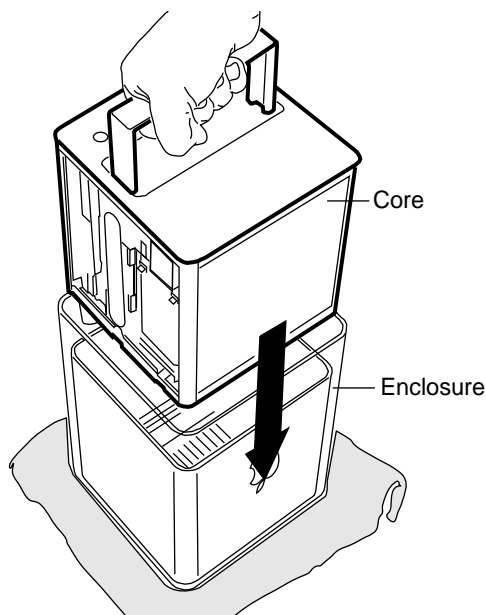

- 2 With a flat hand, press down on the latch until it locks into place. Firmly press the core to ensure it is fully secured within the enclosure.

Important: Do not lift or carry your computer by the core latch. The enclosure could fall off the core and be damaged.

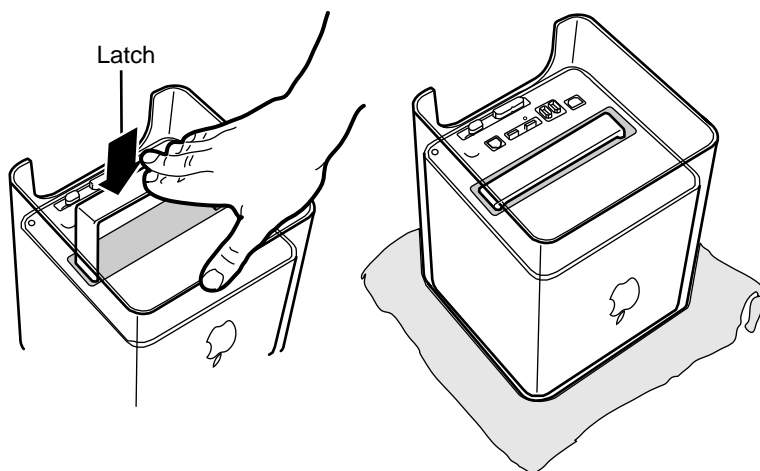

3. Turn your computer upright and reconnect all cables.
4. Restart your computer.

Warning: Never turn on your computer unless all of its internal and external parts are in place and it is closed. Operating the computer when it is open or missing parts can damage your computer or cause injury.

Resetting Date and Time

Replacing the battery changes the date and time settings on your computer. Use the Date & Time control panel to correct the date and time.

 **Apple Computer, Inc.**

© 2000 Apple Computer, Inc. All rights reserved.

Under the copyright laws, this document may not be copied, in whole or in part, without the written consent of Apple.

The Apple logo is a trademark of Apple Computer, Inc., registered in the U.S. and other countries. Use of the “keyboard” Apple logo (Option-Shift-K) for commercial purposes without the prior written consent of Apple may constitute trademark infringement and unfair competition in violation of federal and state laws.

Every effort has been made to ensure that the information in this document is accurate. Apple is not responsible for printing or clerical errors.

Apple Computer, Inc.
1 Infinite Loop
Cupertino, CA 95014-2084
408-996-1010
<http://www.apple.com>

Apple, the Apple logo, Mac, Macintosh, and the Mac logo are trademarks of Apple Computer, Inc., registered in the U.S. and other countries.

Power Mac is a trademark of Apple Computer, Inc.

Power Button Gasket Replacement Instructions

Be sure to follow the instructions in this sheet carefully. Failure to follow these instructions could result in damage to your equipment and may void your warranty.

Replacing your power button gasket requires five basic steps:

- Turn off the computer.
- Remove the computer core from the enclosure.
- Remove the installed gasket.
- Install the replacement gasket.
- Replace the computer core in the enclosure.

Note: Written and video instructions covering customer-installable parts are available at
<http://www.info.apple.com/installparts/>.

Tools Required

No tools are required for this procedure.

Electrostatic Discharge (ESD)

Static electricity, a normal and natural phenomenon, builds up on your body as you walk around. You experience an electrostatic discharge (ESD) when you touch an object and feel a spark. ESD can cause damage to the internal components of your computer. To avoid ESD damage, read and follow all instructions.

Removing the Computer Core From the Enclosure

Warning: Always turn off your computer before opening it to avoid damaging its internal components.

- 1 Place your computer on a clean, flat surface.
- 2 Shut down your computer by opening the Special menu and choosing Shut Down. Then wait five minutes for the computer's internal components to cool down.
- 3 Unplug all cables from the computer except the power cord.

Note: If you have never plugged in your computer, connect the computer's power cord and plug it in.

- 4 Turn the computer on its side on a soft, clean cloth, and ground yourself by touching the bare metal between the video ports.

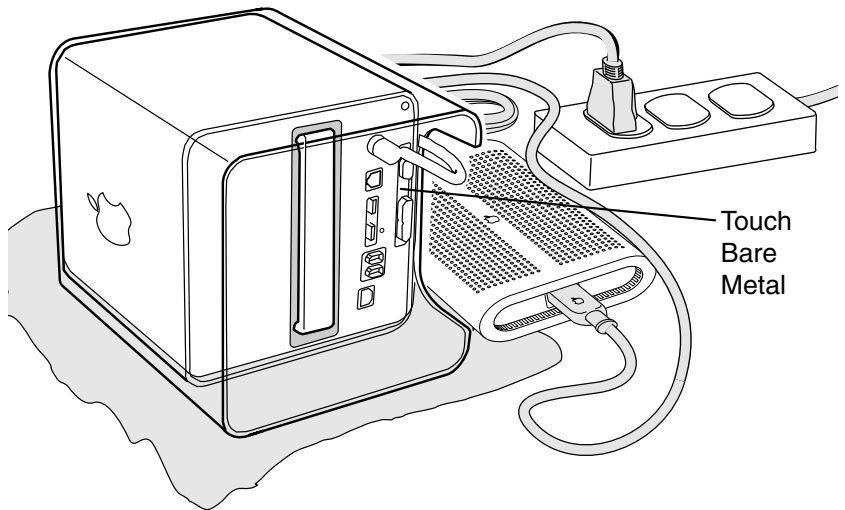

Important: To avoid electrostatic discharge, always ground yourself by touching the bare metal before you touch any parts or install any components inside the computer. To avoid static electricity building back up in your body, do not walk around the room until you have completed the installation and closed the computer.

- 5 Unplug the power cord.

- 6 Turn the computer upside down, and push down on the latch to release it. Allow the latch to extend completely.

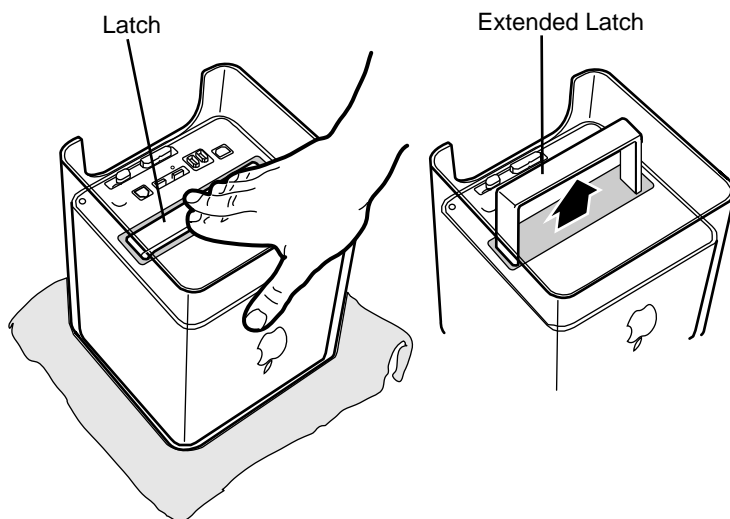

- 7 Gently pull the core from the computer enclosure and place the core on a soft cloth.

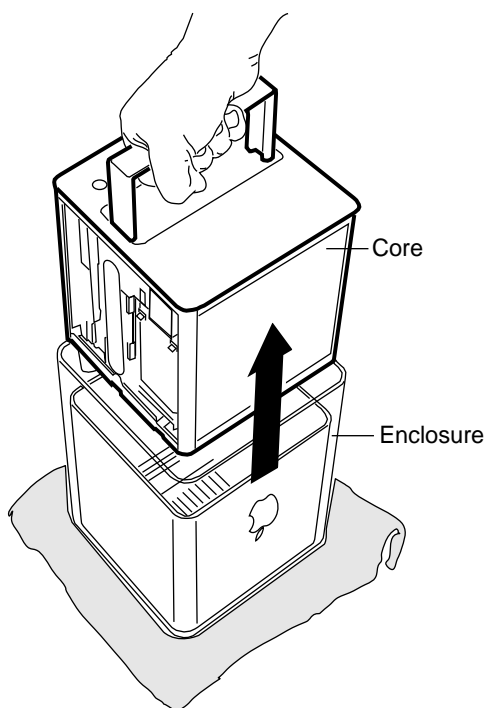

Removing the Power Button Gasket

The power button gasket is a small, flexible, gray ring. Place your hand in the computer enclosure and lift out the installed gasket.

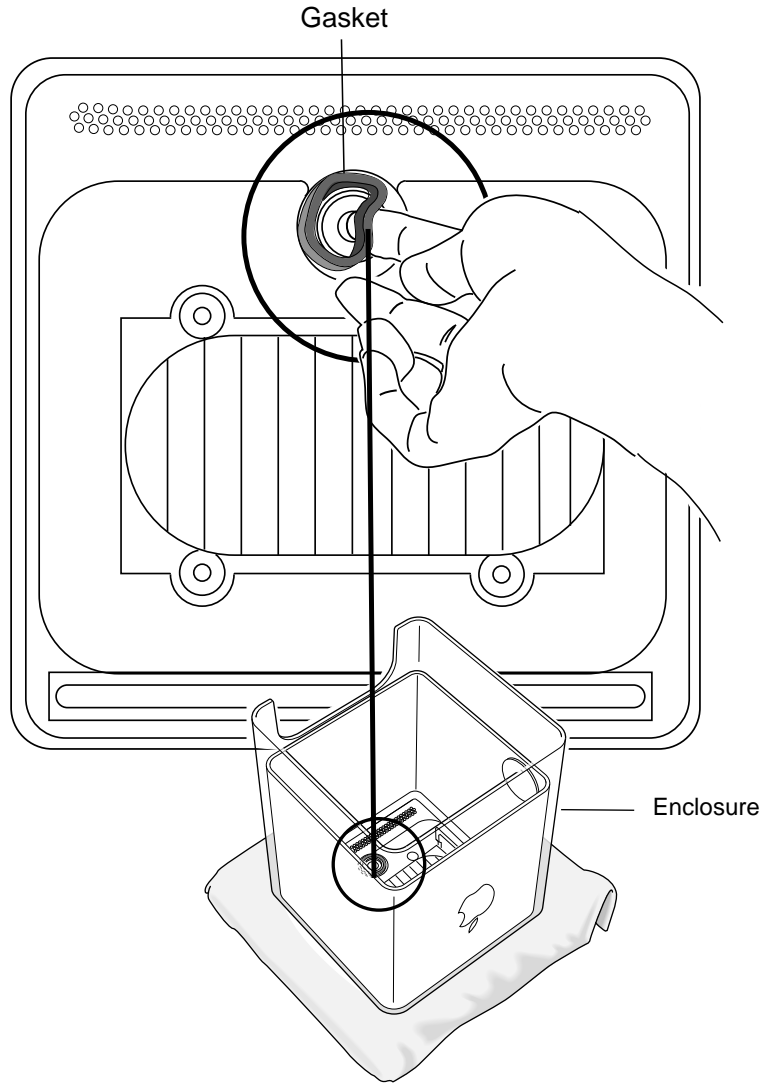

Installing the New Power Button Gasket

- 1 Insert the new power button gasket into the recessed area that encircles the power button.
- 2 Press the gasket into place to ensure that it is secure.
- 3 Install the computer core back into the enclosure as described in the next section.

Replacing the Computer Core in the Enclosure

- 1 Holding the core by the latch, insert the core into the enclosure.

Note: The core fits into the enclosure only one way. Position the core so the ports are toward the back of the enclosure.

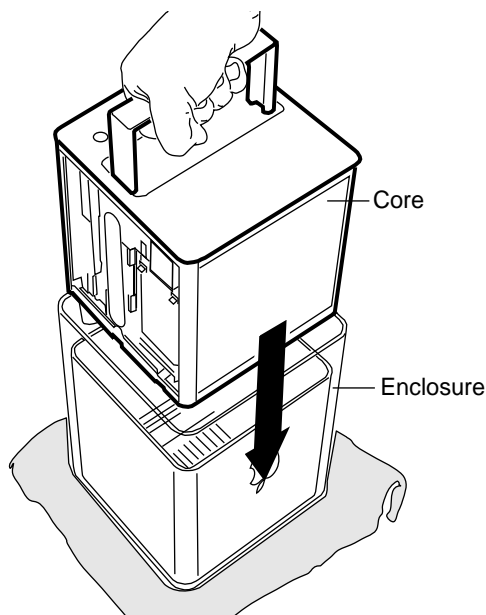

- 2 With a flat hand, press down on the latch until it locks into place. Firmly press the core to ensure it is fully secured within the enclosure.

Important: Do not lift or carry your computer by the core latch. The enclosure could fall off the core and be damaged.

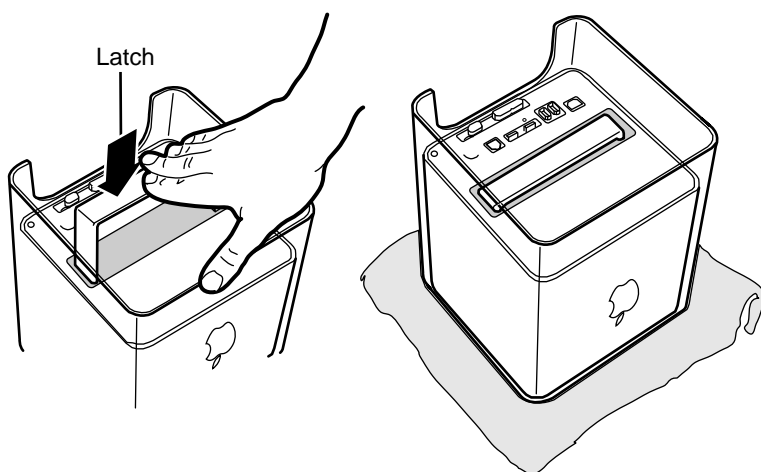

- 3 Turn your computer upright and reconnect all cables.
- 4 Restart your computer.

Warning: Never turn on your computer unless all of its internal and external parts are in place and it is closed. Operating the computer when it is open or missing parts can damage your computer or cause injury.

 **Apple Computer, Inc.**

© 2001 Apple Computer, Inc. All rights reserved.

Under the copyright laws, this document may not be copied, in whole or in part, without the written consent of Apple.

The Apple logo is a trademark of Apple Computer, Inc., registered in the U.S. and other countries. Use of the “keyboard” Apple logo (Option-Shift-K) for commercial purposes without the prior written consent of Apple may constitute trademark infringement and unfair competition in violation of federal and state laws.

Every effort has been made to ensure that the information in this document is accurate. Apple is not responsible for printing or clerical errors.

Apple Computer, Inc.
1 Infinite Loop
Cupertino, CA 95014-2084
408-996-1010
<http://www.apple.com>

Apple, the Apple logo, Mac, Macintosh, and the Mac logo are trademarks of Apple Computer, Inc., registered in the U.S. and other countries.

Power Mac is a trademark of Apple Computer, Inc.

AirPort Card

Replacement Instructions

Be sure to follow these instructions carefully. Failure to follow these instructions could result in damage to your equipment and may void your warranty.

Replacing the AirPort Card in your computer requires five basic steps:

- Turn off the computer.
- Remove the computer core from the enclosure.
- Remove the installed AirPort Card, if applicable.
- Install the replacement AirPort Card.
- Replace the computer core in the enclosure.

Note: Written and video instructions covering customer-installable parts are available at:

<http://www.info.apple.com/installparts/>.

Tools Required

No tools are required for this procedure.

Electrostatic Discharge (ESD)

Static electricity, a normal and natural phenomenon, builds up on your body as you walk around. You experience an electrostatic discharge (ESD) when you touch an object and feel a spark. ESD can cause damage to the internal components of your computer. To avoid ESD damage, read and follow all instructions.

Removing the Computer Core From the Enclosure

Warning: Always turn off your computer before opening it to avoid damaging its internal components.

- 1 Place your computer on a clean, flat surface.
- 2 Shut down your computer by opening the Special menu and choosing Shut Down. Then wait five minutes for the computer's internal components to cool down.
- 3 Unplug all cables from the computer except the power cord.

Note: If you have never plugged in your computer, connect the computer's power cord and plug it in.

- 4 Turn the computer on its side on a soft, clean cloth, and ground yourself by touching the bare metal between the video ports.

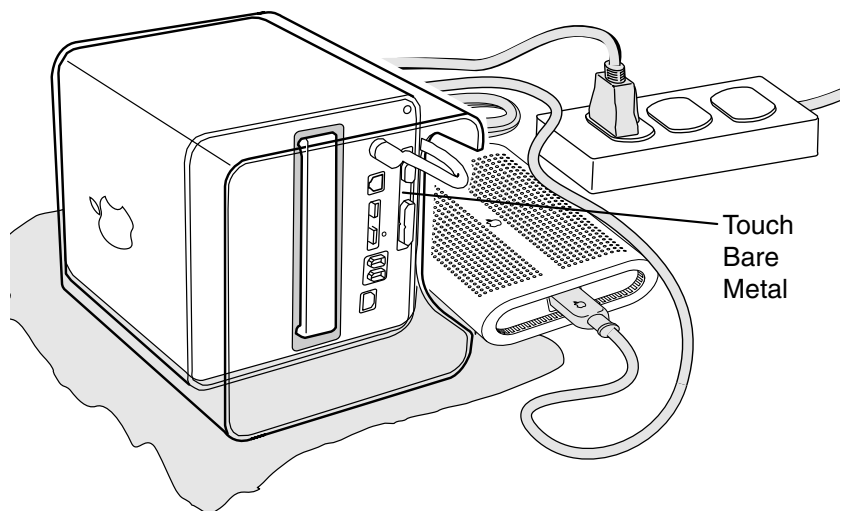

Important: To avoid electrostatic discharge, always ground yourself by touching the bare metal before you touch any parts or install any components inside the computer. To avoid static electricity building back up in your body, do not walk around the room until you have completed the installation and closed the computer.

- 5 Unplug the power cord.

- 6 Turn the computer upside down, and push down on the latch to release it. Allow the latch to extend completely.

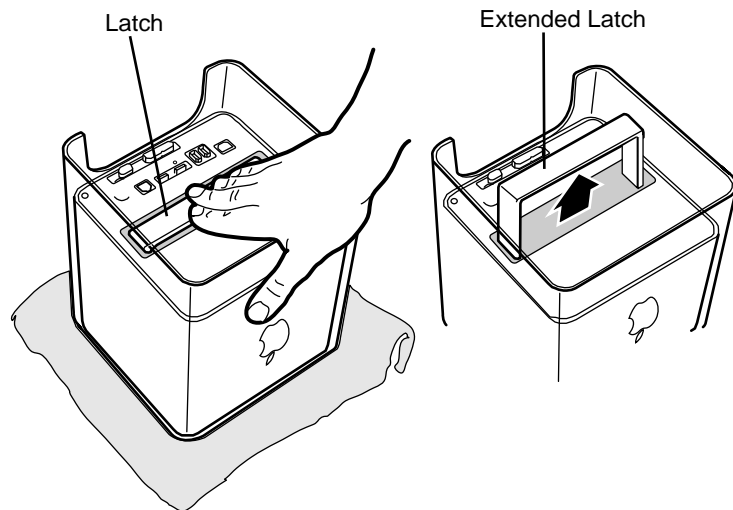

- 7 Gently pull the core from the computer enclosure and place the core on a soft cloth.

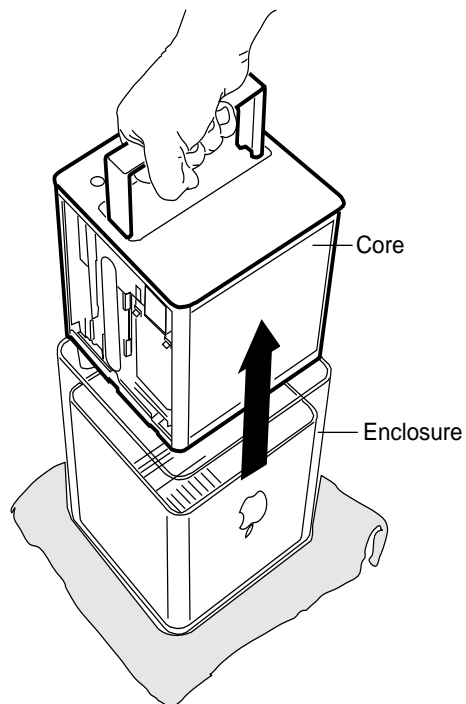

Removing an AirPort Card

- 1 Disconnect the coaxial antenna cable from the port on the end of the AirPort Card.
- 2 Pull the plastic tab on the end of the AirPort Card to release the AirPort Card from the PCI card connector.

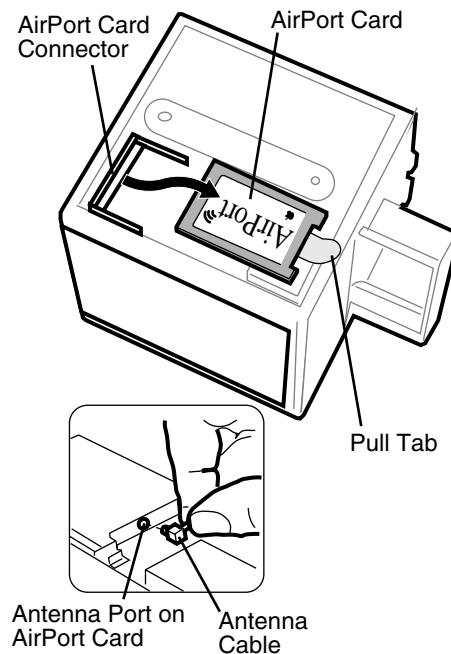

Installing an AirPort Card

- 1 Insert the AirPort Card through the opening in the PCI card guide and into the connector on the logic board.
- 2 Carefully attach the coaxial antenna cable to the port on the end of the AirPort Card.

Note: The antenna cable might be stowed on the side of the PCI card guide. Do not bend or crimp the cable tightly.

Replacing the Computer Core in the Enclosure

- 1 Holding the core by the latch, insert the core into the enclosure.

Note: The core fits into the enclosure only one way. Position the core so the ports are toward the back of the enclosure.

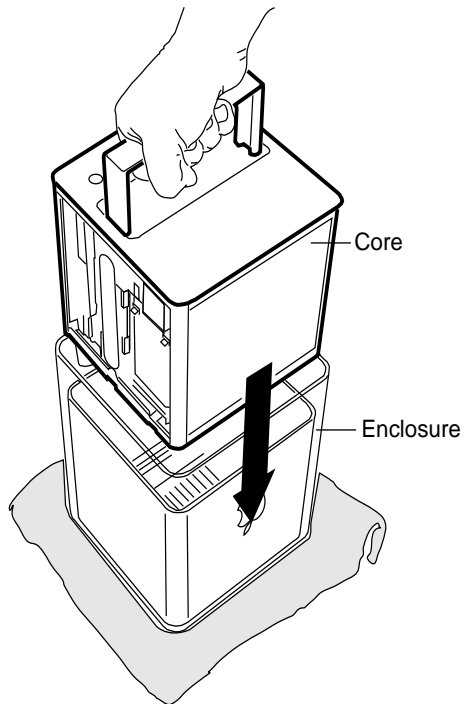

- 2 With a flat hand, press down on the latch until it locks into place. Firmly press the core to ensure it is fully secured within the enclosure.

Important: Do not lift or carry your computer by the core latch. The enclosure could fall off the core and be damaged.

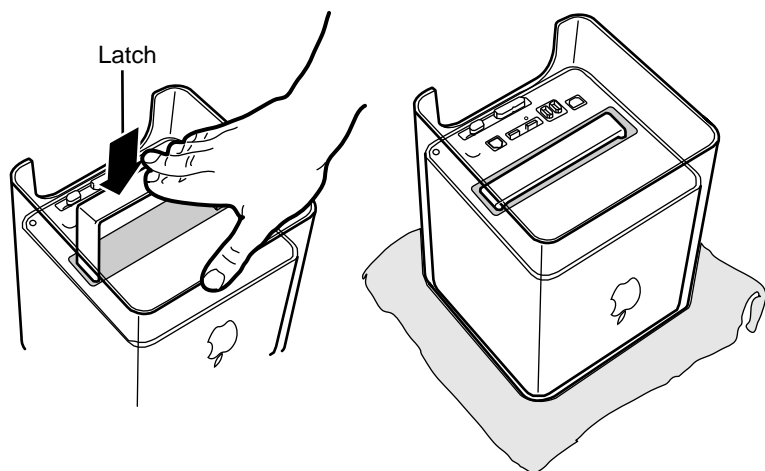

-
- 3 Turn your computer upright and reconnect all cables.
 - 4 Restart your computer.

Warning: Never turn on your computer unless all of its internal and external parts are in place and it is closed. Operating the computer when it is open or missing parts can damage your computer or cause injury.

🍏 Apple Computer, Inc.

© 2001 Apple Computer, Inc. All rights reserved.

Under the copyright laws, this document may not be copied, in whole or in part, without the written consent of Apple.

The Apple logo is a trademark of Apple Computer, Inc., registered in the U.S. and other countries. Use of the “keyboard” Apple logo (Option-Shift-K) for commercial purposes without the prior written consent of Apple may constitute trademark infringement and unfair competition in violation of federal and state laws.

Every effort has been made to ensure that the information in this document is accurate. Apple is not responsible for printing or clerical errors.

Apple Computer, Inc.
1 Infinite Loop
Cupertino, CA 95014-2084
408-996-1010
<http://www.apple.com>

Apple, the Apple logo, Mac, Macintosh, and the Mac logo are trademarks of Apple Computer, Inc., registered in the U.S. and other countries.

AirPort and Power Mac are trademarks of Apple Computer, Inc.

Memory (DRAM DIMM) Replacement Instructions

Be sure to follow the instructions in this sheet carefully. Failure to follow these instructions could result in damage to your equipment and may void your warranty.

Replacing memory in your computer requires five basic steps:

- Turn off the computer.
- Remove the computer core from the enclosure.
- Remove the DRAM DIMM you are replacing.
- Install the replacement DRAM DIMM in its slot.
- Replace the computer core in the enclosure.

Note: A video version of the replacement instructions is available at <http://www.info.apple.com/installparts>

Tools Required

No tools are required for this procedure.

Electrostatic Discharge (ESD)

Static electricity, a normal and natural phenomenon, builds up on your body as you walk around. You experience an electrostatic discharge (ESD) when you touch an object and feel a spark. ESD can cause damage to the internal components of your computer.

To avoid ESD damage, read and follow all instructions. If a grounding wrist strap is included with your replacement memory, refer to the instructions included for how to ground and use the strap.

About Memory

Memory cards called Dual Inline Memory Modules (DIMMs) provide dynamic random-access memory (DRAM) to your computer. The DIMMs are installed in three memory slots on the logic board.

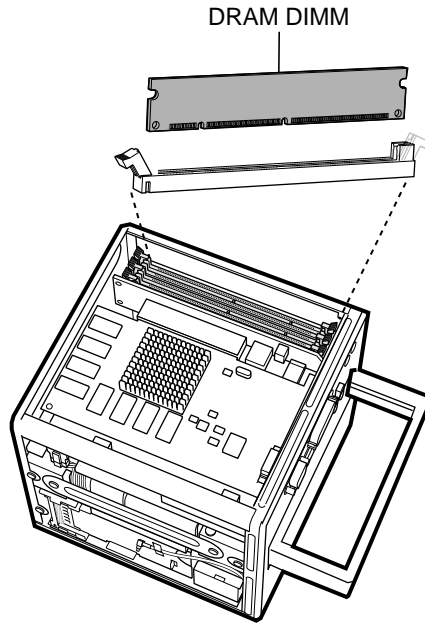

Your computer uses synchronous DRAM (SDRAM) DIMMs that must be compatible with the computer's specifications. Replace the DIMM in your computer with the replacement DIMM provided in this package. Do not use DRAM DIMMs from older computers, even if they fit into the DIMM slots.

Note: Different size DRAM DIMMs can be installed in any order in any DIMM slot. You also do not have to install DIMMs in pairs, as in some older Macintosh computers.

Removing the Computer Core from the Enclosure

Warning: Always turn off your computer before opening it to avoid damaging its internal components.

- 1 Place your computer on a clean, flat surface.
- 2 Shut down your computer by opening the Special menu and choosing Shut Down. Then wait five minutes for the computer's internal components to cool down.
- 3 Unplug all cables from the computer except the power cord.

Note: If you have never plugged in your computer, connect the computer's power cord and plug it in.

- 4 Turn your computer upside down on a soft, clean cloth.
- 5 Touch the bare metal at the port access covers on the back of the computer.

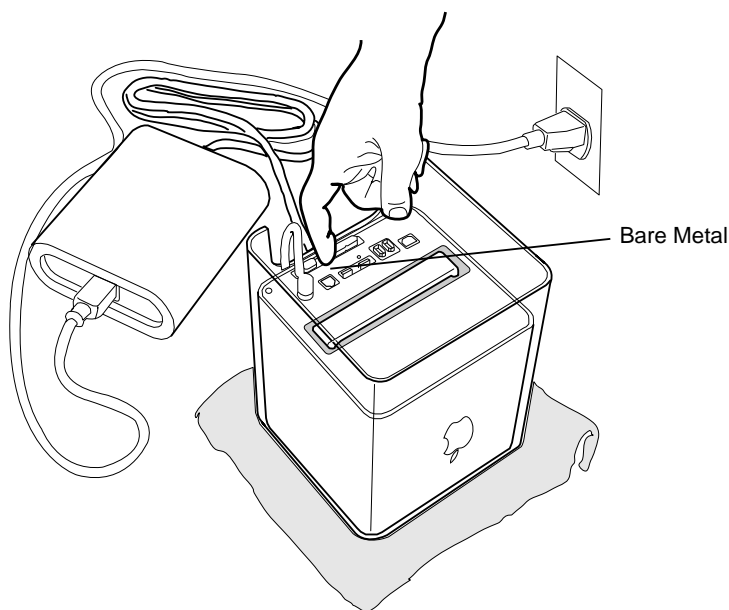

Important: To avoid electrostatic discharge, always ground yourself by touching the port access covers before you touch any parts or install any components inside the computer. To avoid static electricity building back up in your body, do not walk around the room until you have completed the installation and closed the computer.

- 6 Unplug the power cord.

- 7 Push down on the latch to release it.

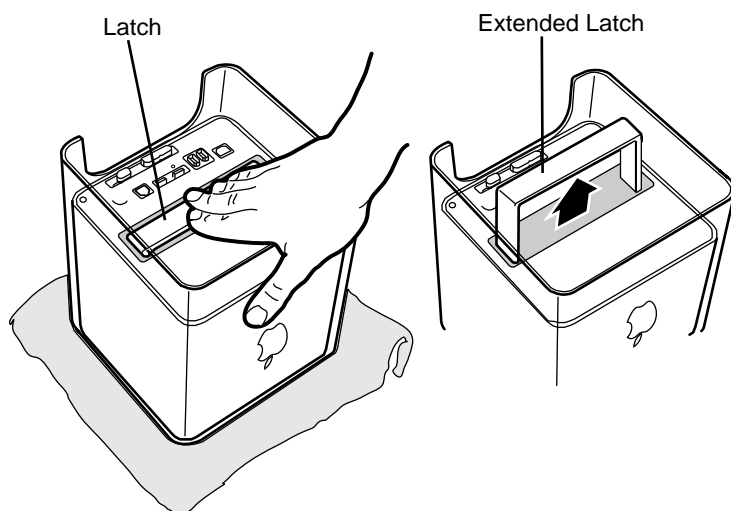

Allow the latch to extend completely.

- 8 Gently pull the core from the computer enclosure and place the core on a soft cloth.

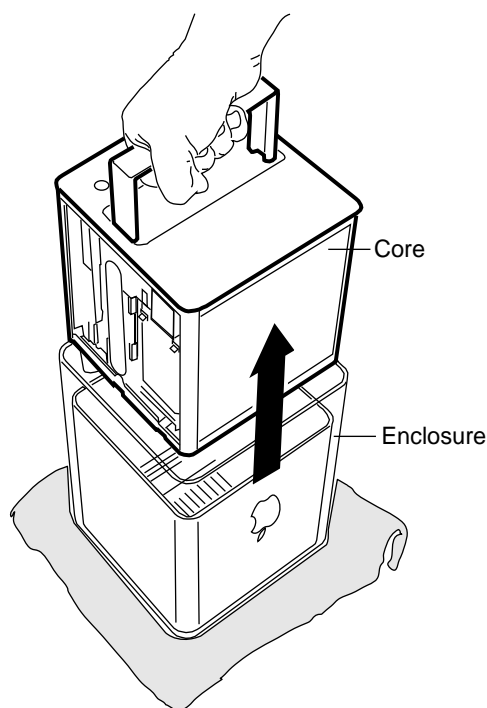

Removing the Installed DIMM

- 1 If provided, attach the grounding wrist strap included with your replacement memory. Refer to the instructions on the wrist strap for how to ground and use the strap.
- 2 Push down the ejectors on the slot of the DIMM you want to replace.

Note: The slot might have one or two ejectors.

- 3 Lift the DIMM out of the computer.

Warning: When removing or installing the DIMM, do not touch its connectors. Handle the DIMM only by the edges.

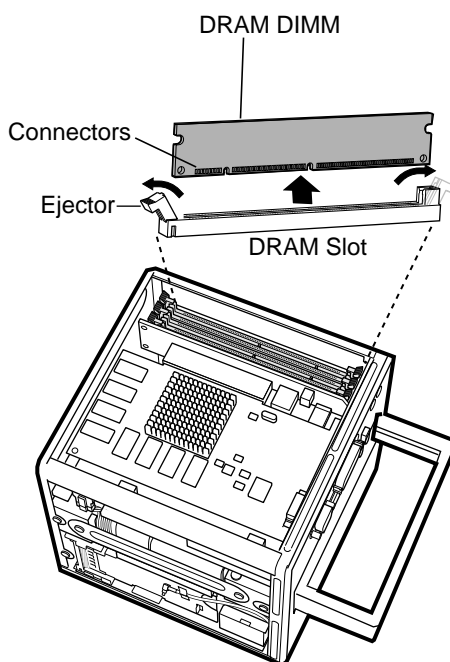

Installing the Replacement DIMM

- 1 Remove the replacement DIMM from its static-proof bag, taking care not to touch the connectors or chips.
- 2 Align the replacement DIMM in the DIMM slot. Press the DIMM down firmly until you feel it securely attach to the slot, and the ejectors lock it into place.

Replacing the Computer Core in the Enclosure

- 1 Holding the core by the latch, insert the core into the enclosure.

Note: The core fits into the enclosure only one way. Position the core so the ports are toward the back of the enclosure.

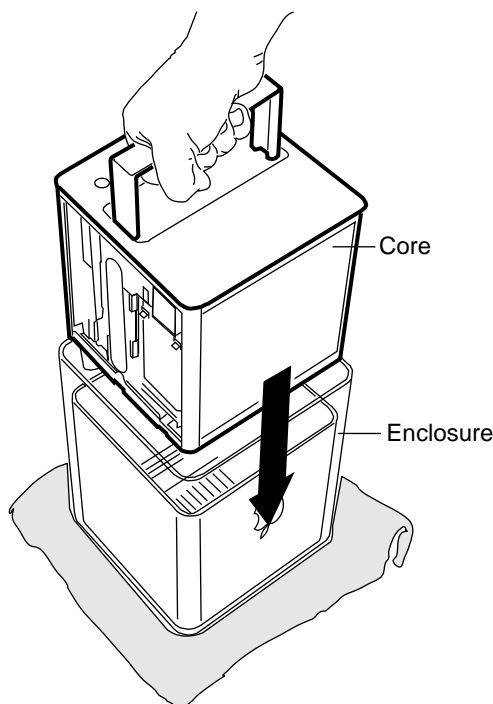

- 2 With a flat hand, press down on the latch until it locks into place. Firmly press the core to ensure it is fully secured within the enclosure.

Important: Do not lift or carry your computer by the core latch. The enclosure could fall off the core and be damaged.

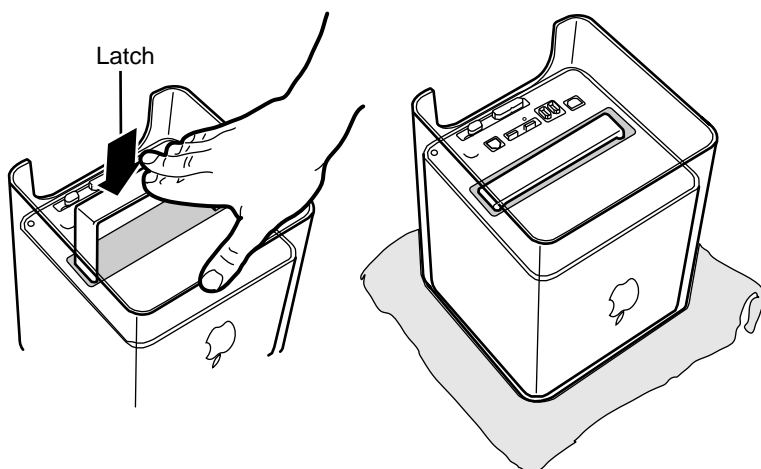

- 3 Turn your computer upright and reconnect all cables.
- 4 Restart your computer.

Warning: Never turn on your computer unless all of its internal and external parts are in place and it is closed. Operating the computer when it is open or missing parts can damage your computer or cause injury.

Repackaging the DIMM

Repackage the DIMM you removed from the computer in the static-proof bag and box that you received with the replacement DIMM. Seal the box with the tape included, and affix the return label.

 **Apple Computer, Inc.**

© 2000 Apple Computer, Inc. All rights reserved.

Under the copyright laws, this document may not be copied, in whole or in part, without the written consent of Apple.

The Apple logo is a trademark of Apple Computer, Inc., registered in the U.S. and other countries. Use of the “keyboard” Apple logo (Option-Shift-K) for commercial purposes without the prior written consent of Apple may constitute trademark infringement and unfair competition in violation of federal and state laws.

Every effort has been made to ensure that the information in this document is accurate. Apple is not responsible for printing or clerical errors.

Apple Computer, Inc.
1 Infinite Loop
Cupertino, CA 95014-2084
408-996-1010
<http://www.apple.com>

Apple, the Apple logo, Mac, Macintosh, and the Mac logo are trademarks of Apple Computer, Inc., registered in the U.S. and other countries.

Power Mac is a trademark of Apple Computer, Inc.

ATA Hard Drive Replacement Instructions

Be sure to follow these instructions carefully. Failure to follow these instructions could result in damage to your equipment and may void your warranty.

Replacing the ATA hard drive in your computer requires five basic steps:

- Turn off the computer.
- Remove the computer core from the enclosure.
- Remove the installed ATA drive.
- Install the replacement ATA drive.
- Replace the computer core in the enclosure.

Note: Written and video instructions covering customer-installable parts are available at

<http://www.info.apple.com/installparts/>.

Tools Required

- Flat-blade screwdriver
- Torx T-8 screwdriver
- Phillips screwdriver

Electrostatic Discharge (ESD)

Static electricity, a normal and natural phenomenon, builds up on your body as you walk around. You experience an electrostatic discharge (ESD) when you touch an object and feel a spark. ESD can cause damage to the internal components of your computer. To avoid ESD damage, read and follow all instructions.

Backing Up Your Data

Warning: Before replacing your hard drive, make sure you back up all data on the drive.

Removing the Computer Core From the Enclosure

- 1 Place your computer on a clean, flat surface.
- 2 Shut down your computer by opening the Special menu and choosing Shut Down. Then wait five minutes for the computer's internal components to cool down.
- 3 Unplug all cables from the computer except the power cord.

Note: If you have never plugged in your computer, connect the computer's power cord and plug it in.

- 4 Turn the computer on its side on a soft, clean cloth, and ground yourself by touching the bare metal between the video ports.

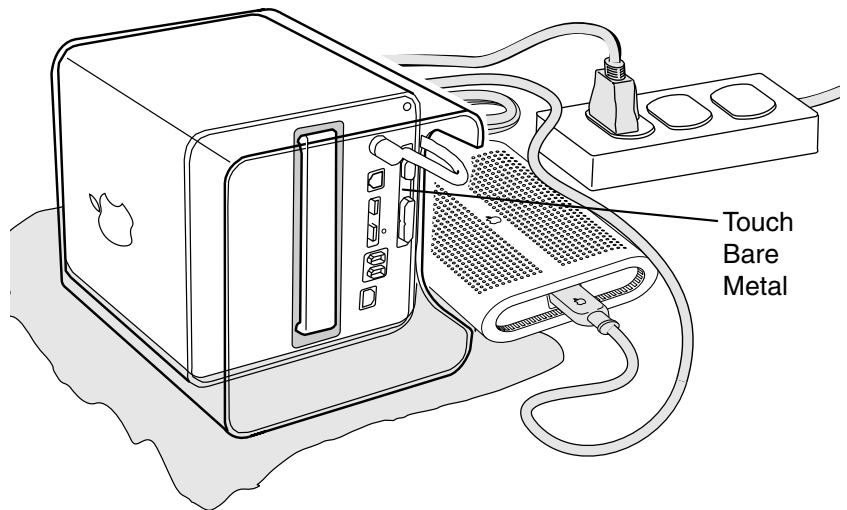

Important: To avoid electrostatic discharge, always ground yourself by touching the bare metal before you touch any parts or install any components inside the computer. To avoid static electricity building back up in your body, do not walk around the room until you have completed the installation and closed the computer.

- 5 Unplug the power cord.

- 6 Turn the computer upside down, and push down on the latch to release it. Allow the latch to extend completely.

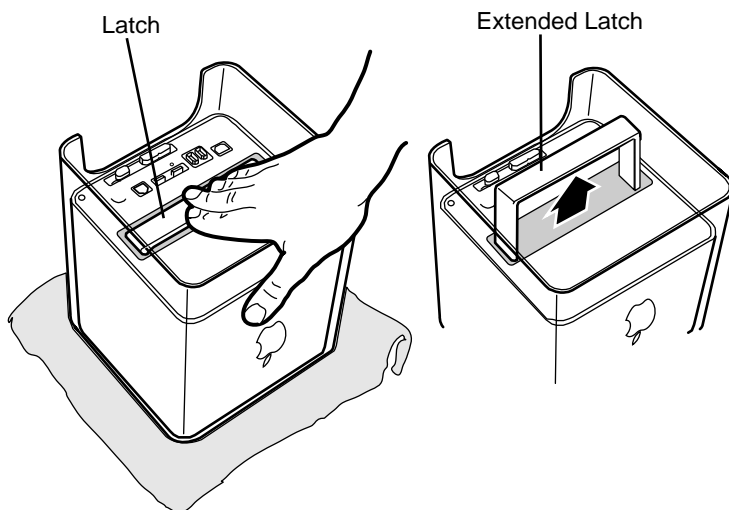

- 7 Gently pull the core from the computer enclosure and place the core on a soft cloth.

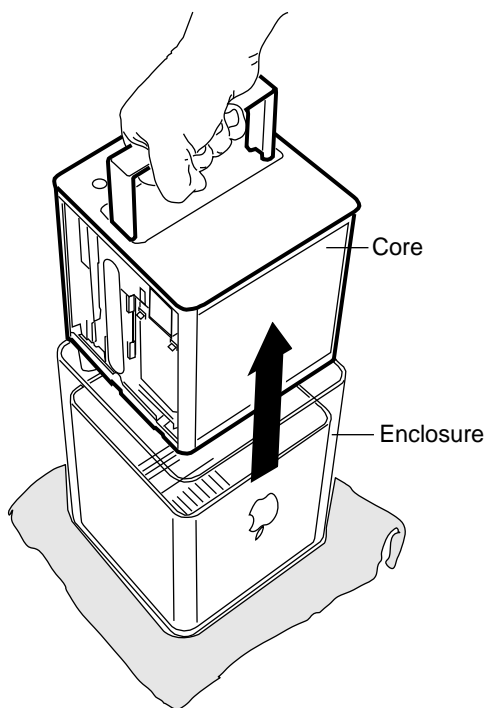

Removing the Installed Drive

- 1 Remove the AirPort Card, if installed.
- 2 Press and hold the door latch, and then open the AirPort shield door.

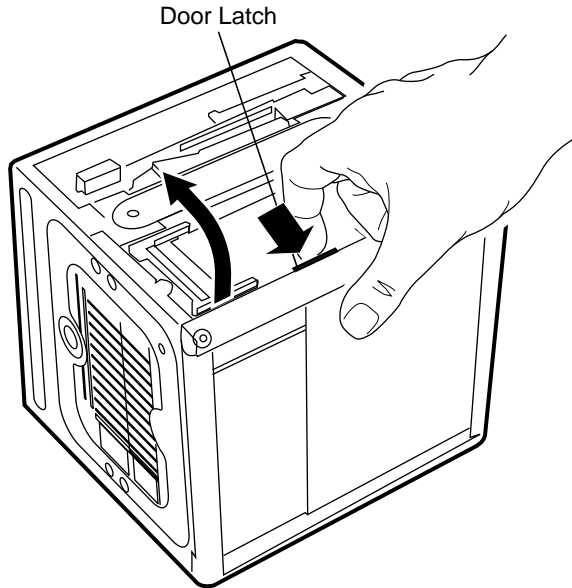

- 3 With the AirPort shield door open, pull the tab to disconnect the ATA ribbon cable connector from the hard drive.
- 4 Disconnect the power cable connector from the hard drive. (You might need to use a flat-blade screwdriver to pry up and loosen the connector.)

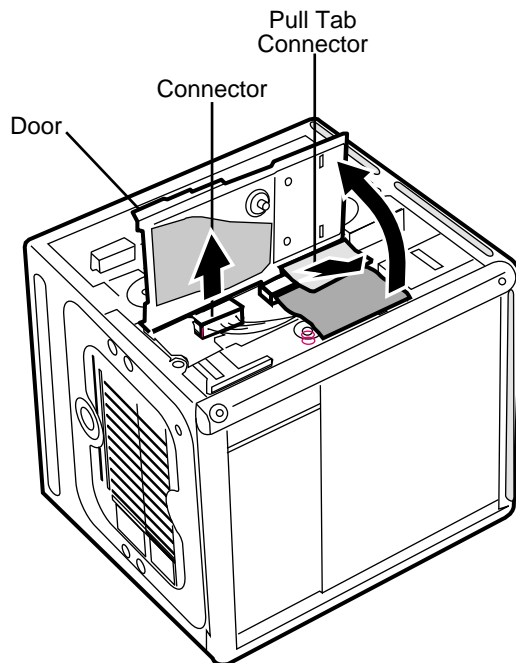

- 5 Push in the core latch, and reposition the computer chassis so you can access the heatsink and hard drive.
- 6 Loosen, but do not remove, the three captive screws at the heatsink.
- 7 Lift up the loosened heatsink, and slide the hard drive out of the carrier.

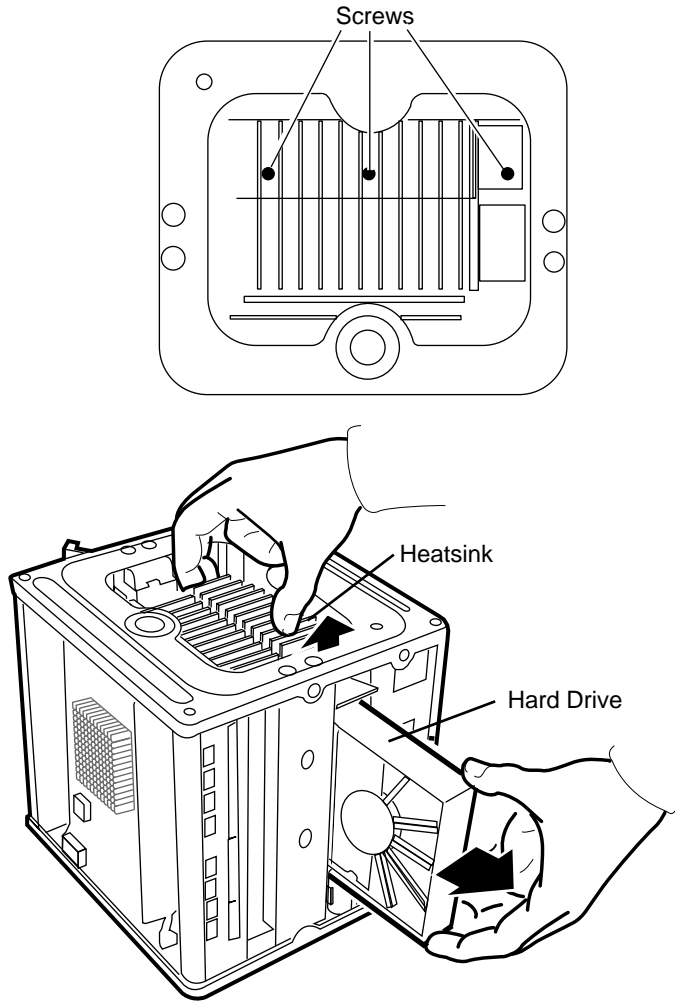

Installing the Replacement Drive

- 1 Position the replacement drive on the drive carrier so that the ribbon cable and power cable connectors align with the slots at the end of the carrier.
- 2 Lift up the heatsink, and slide in the drive.
- 3 Align the heatsink fins to the opposite heatsink fins. Tighten the three captive screws.

- 4 Reconnect the power cable connector and the ATA ribbon cable connector to the drive.

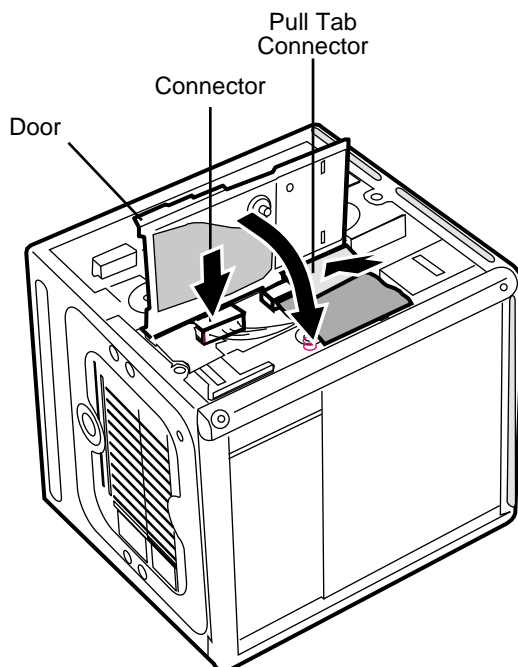

- 5 Close the AirPort shield door, and press it down so the door latch engages.

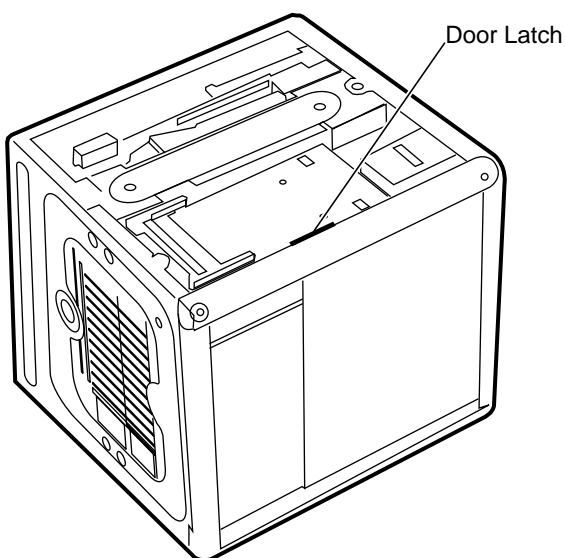

- 6 Reinstall the AirPort Card, if applicable.

Replacing the Computer Core in the Enclosure

- 1 Holding the core by the latch, insert the core into the computer.

Note: The core fits into the enclosure only one way. Position the core so the ports are toward the back of the enclosure.

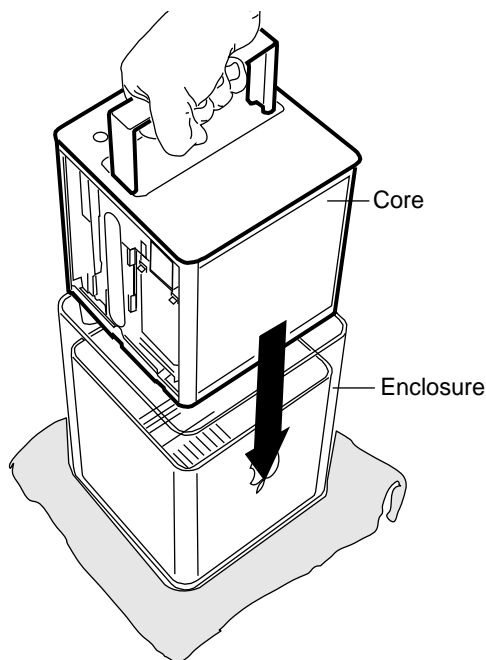

- 2 With a flat hand, press down on the latch until it locks into place. Firmly press the core to ensure it is fully secured within the enclosure.

Important: Do not lift or carry your computer by the core latch. The enclosure could fall off the core and be damaged.

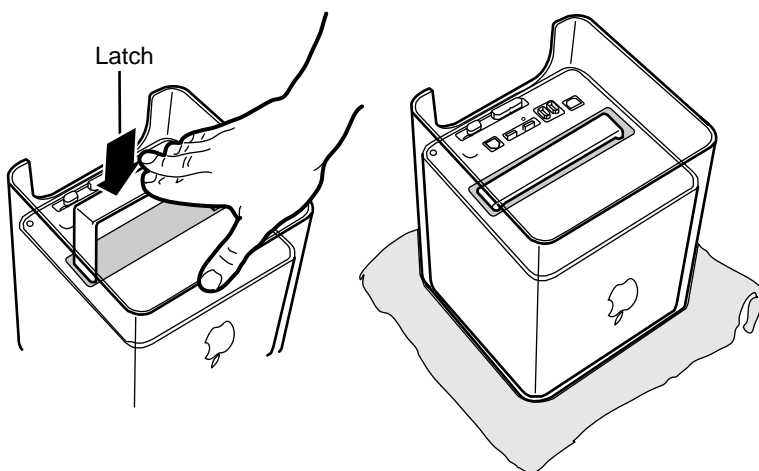

- 3 Turn your computer upright and reconnect all cables.
- 4 Restart your computer and restore the data from your backup to the new drive.

Warning: Never turn on your computer unless all of its internal and external parts are in place and it is closed. Operating the computer when it is open or missing parts can damage your computer or cause injury.

Repackaging the Drive

Repackage the drive you removed from the computer in the static-proof bag and box that you received with the replacement drive. Seal the box and affix the return label with the tape and label included in the box.

 **Apple Computer, Inc.**

© 2001 Apple Computer, Inc. All rights reserved.

Under the copyright laws, this document may not be copied, in whole or in part, without the written consent of Apple.

The Apple logo is a trademark of Apple Computer, Inc., registered in the U.S. and other countries. Use of the “keyboard” Apple logo (Option-Shift-K) for commercial purposes without the prior written consent of Apple may constitute trademark infringement and unfair competition in violation of federal and state laws.

Every effort has been made to ensure that the information in this document is accurate. Apple is not responsible for printing or clerical errors.

Apple Computer, Inc.
1 Infinite Loop
Cupertino, CA 95014-2084
408-996-1010
<http://www.apple.com>

Apple, the Apple logo, Mac, Macintosh, and the Mac logo are trademarks of Apple Computer, Inc., registered in the U.S. and other countries.

AirPort and Power Mac are trademarks of Apple Computer, Inc.



DC-to-DC Board Replacement Instructions

The following instructions explain how to replace the DC-to-DC board in the Power Mac G4 Cube.

Tools Required

The only tool required for this procedure is a Torx T-10 screwdriver.

Removing the Computer Core From the Enclosure

Warning: Always turn off your computer before opening it to avoid damaging its internal components.

- 1 Shut down the computer and wait five minutes for the internal components to cool down.
- 2 Unplug all cables from the computer except the power cord.
- 3 Turn the computer on its side on a soft, clean cloth, and ground yourself by touching the bare metal between the video ports.

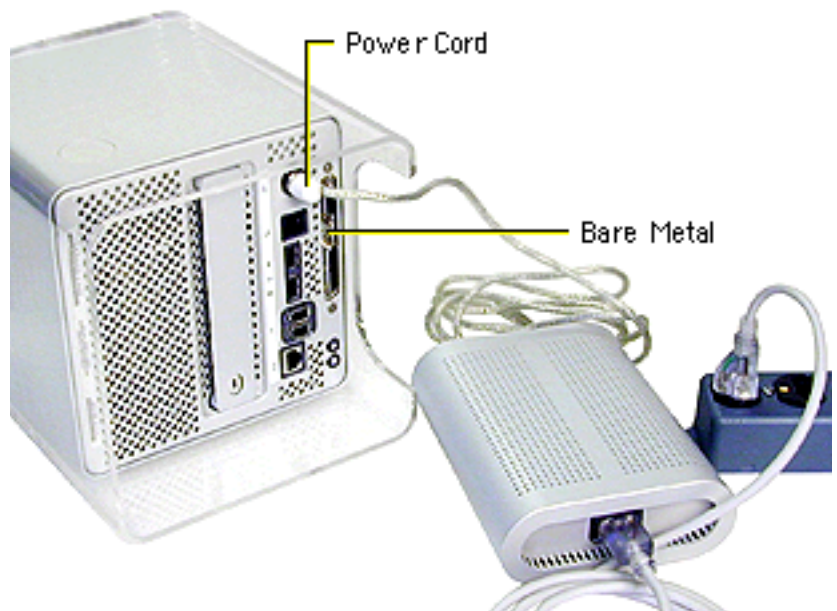

Important: To avoid electrostatic discharge, always ground yourself by touching the bare metal before you touch any parts or install any components inside the computer. To avoid static electricity building back up in your body, do not walk around the room until you have completed the installation and closed the computer.

- 4 Unplug the power cord.
- 5 Turn the computer upside down and push on the latch to release the lock. Allow the latch to extend completely.

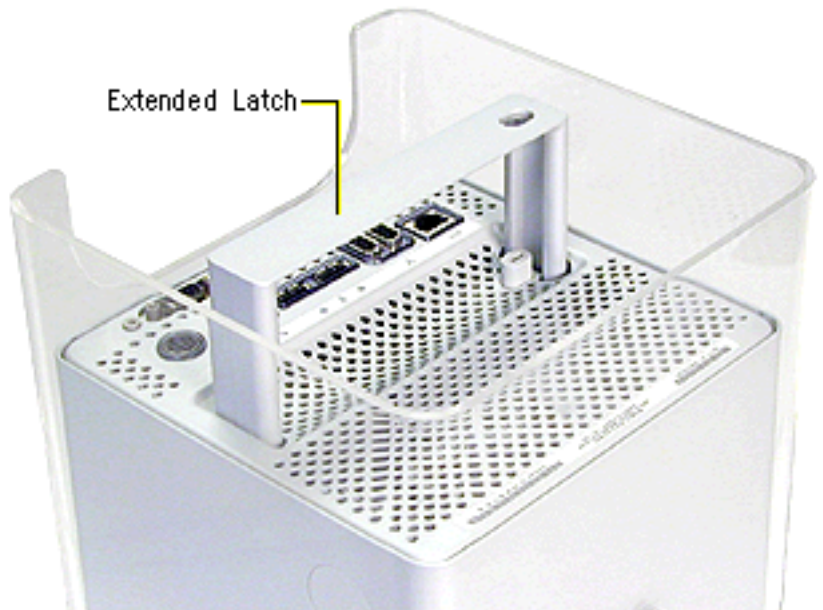

- 6 Gently pull up the core and place it on a soft cloth



Removing the DC-to-DC Board

- 1 Turn the core on its side so the DC-to-DC board is directly in front of you, as shown below.

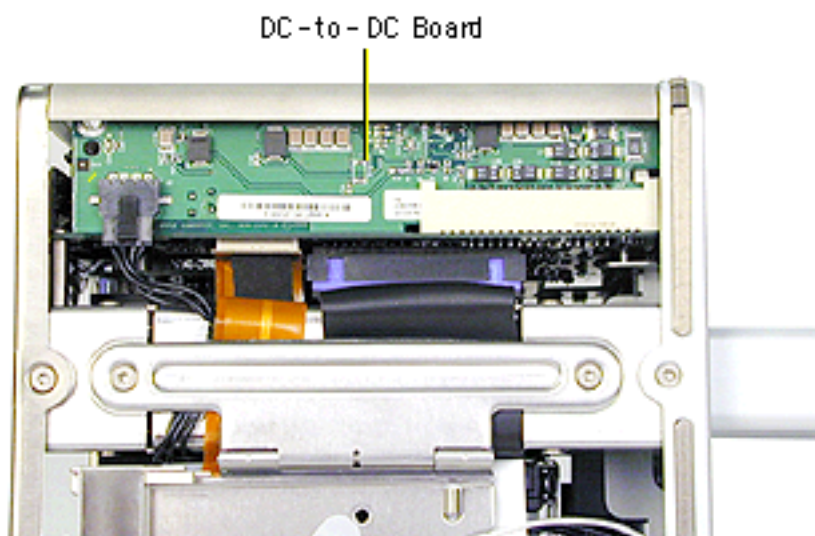

- 2 Check the upper left corner of the DC-to-DC board. If there is a metal clip on the corner of the board, remove the screw from the clip, then lift off the clip.

Note: The metal clip is not present nor required on all production models.

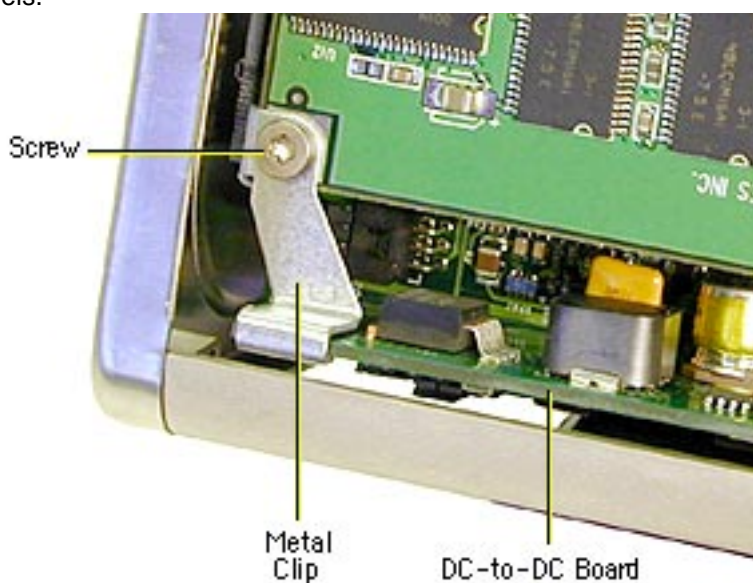

- 3 Disconnect the power cable connector (J2) on the lower left corner of the board and gently move the cable out of the way.
- 4 Locate the white, ridged ejector on the right end of the board.

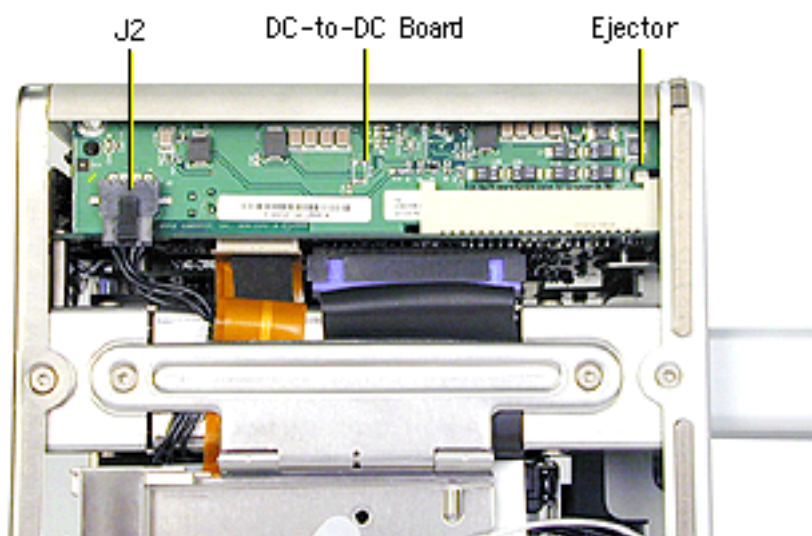

- 5 Looking down at the top edge of the board, use a screwdriver to press the ridged ejector away from the locking slot in the board.

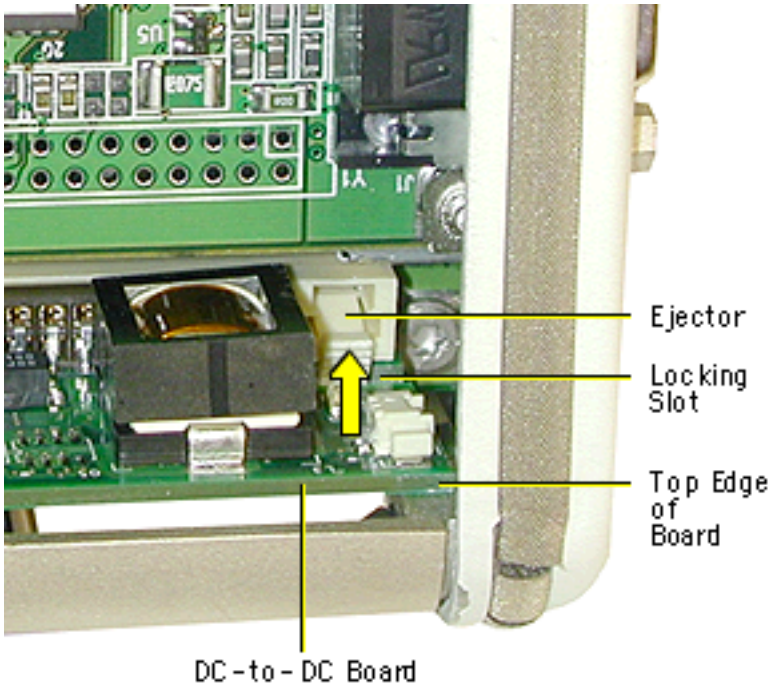

- 6 With one hand, grasp the left corner of the board, and with the other hand insert your index finger underneath the board to tilt the board up.

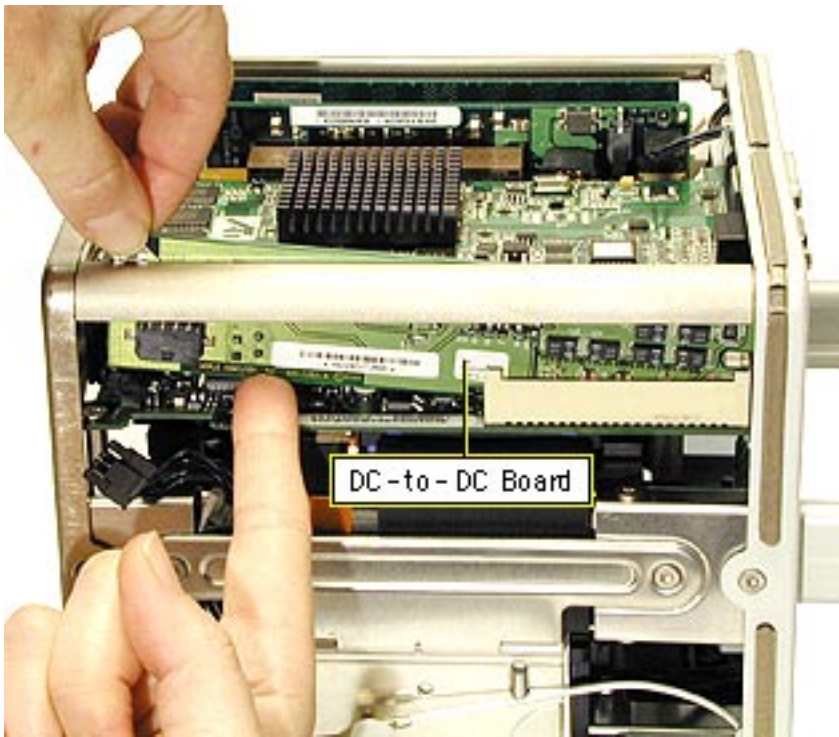

- 7 Gently rock and lift the board out of the chassis, being careful not to touch or scrape any components.

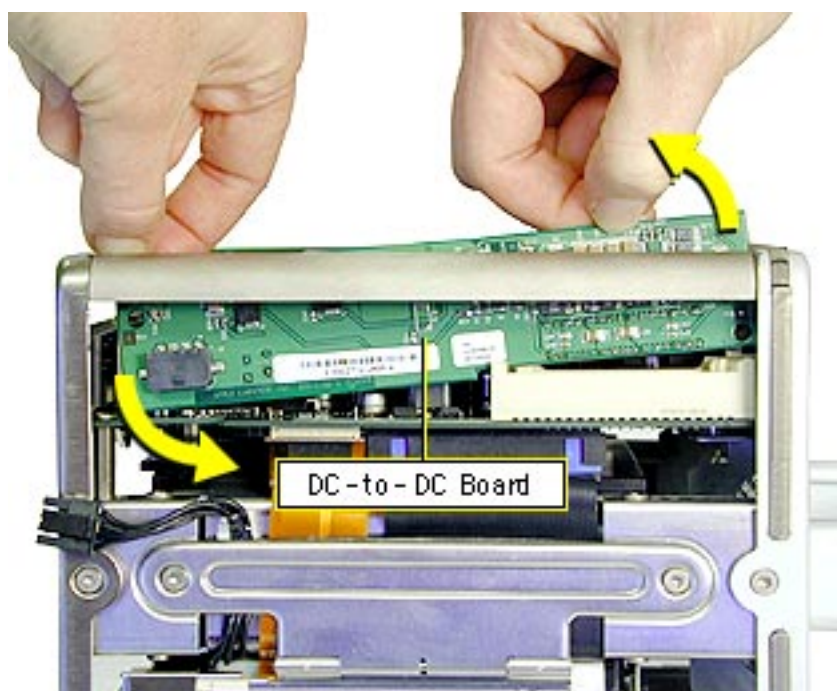

Installing the New DC-to-DC Board

- 1 Check that the ejector on the connector is tipped back (not blocking the connector slot).

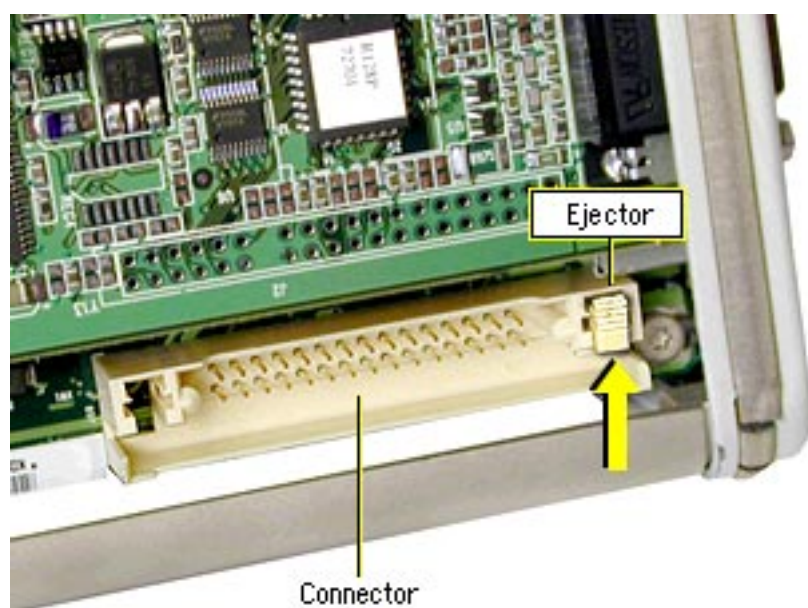

- 2 Holding the replacement DC-to-DC board by the top edge, position the right end of the board over the board connector. Tilt the left end of the board down first, and then insert the right end of the board into the connector.
- 3 Press the board into the connector so the board is fully seated and the ejector engages in the board slot.

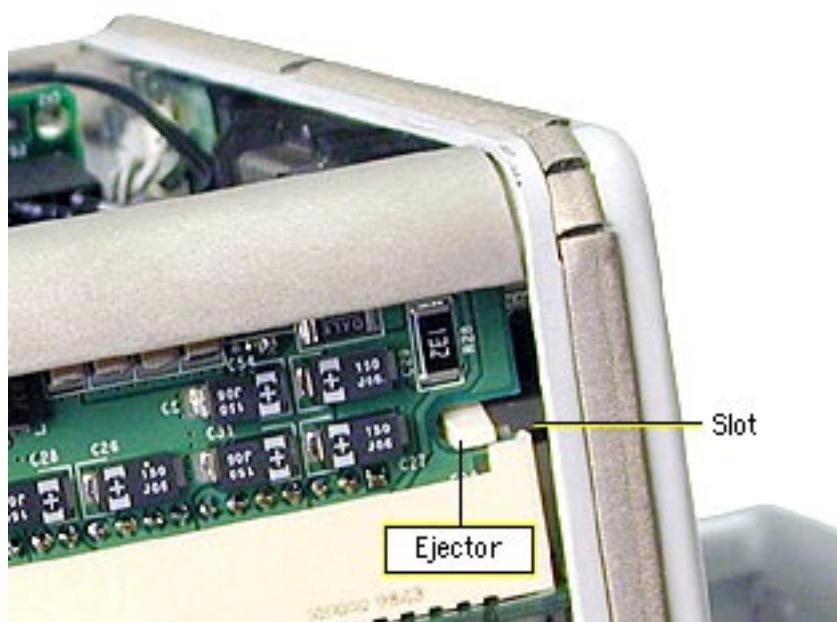

- 4 Connect the power cable (J2).
- 5 Tuck in the power cable so it cannot be caught when replacing the core in the enclosure.

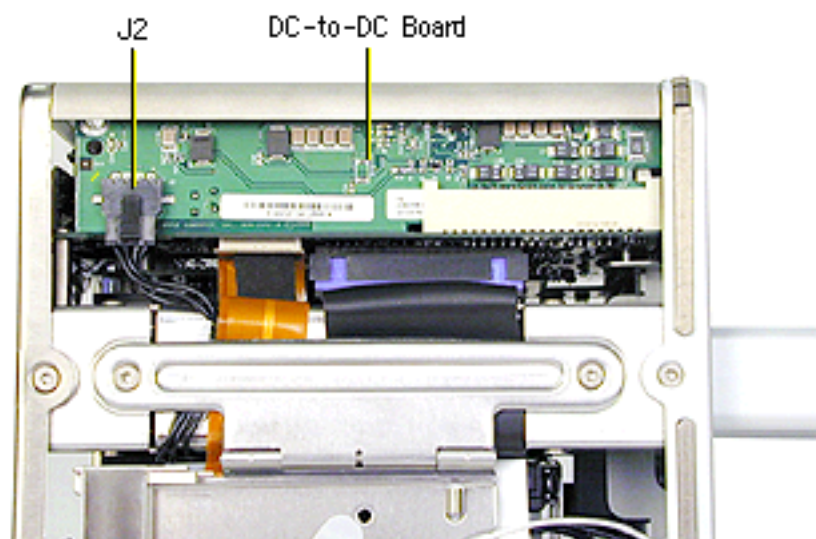

Replacing the Computer Core in the Enclosure

- 1 Holding the core by the latch, insert the core into the enclosure. (The core fits only one way, with the ports toward the back of the computer.)
- 2 With a flat hand, press down on the latch until it locks into place. Firmly press the core to ensure it is fully secured within the enclosure.

Important: Do not lift or carry the computer by the core latch. The enclosure could fall off the core and be damaged.

- 3 Turn the computer upright and reconnect all cables.
- 4 Restart the computer.

Warning: Never turn on the computer unless all of its internal and external parts are in place and it is closed. Operating the computer when it is open or missing parts can damage the computer or cause injury.

Apple Computer, Inc.

© 2000 Apple Computer, Inc. All rights reserved.

Under the copyright laws, this document may not be copied, in whole or in part, without the written consent of Apple.

The Apple logo is a trademark of Apple Computer, Inc., registered in the U.S. and other countries. Use of the “keyboard” Apple logo (Option-Shift-K) for commercial purposes without the prior written consent of Apple may constitute trademark infringement and unfair competition in violation of federal and state laws.

Every effort has been made to ensure that the information in this document is accurate. Apple is not responsible for printing or clerical errors.

Apple Computer, Inc.
1 Infinite Loop
Cupertino, CA 95014-2084
408-996-1010
<http://www.apple.com>

Apple, the Apple logo, Mac, Macintosh, and the Mac logo are trademarks of Apple Computer, Inc., registered in the U.S. and other countries.

Power Mac is a trademark of Apple Computer, Inc.

Top Plate Assembly with Power Button Gasket

Replacement Instructions

The following instructions explain how to replace the top plate assembly and power button gasket in the Power Mac G4 Cube.

Tools Required

The only tool required for this procedure is a Torx T-10 screwdriver.

Removing the Computer Core From the Enclosure

⚠ WARNING: Always turn off the computer before opening it to avoid damaging its internal components.

- 1 Shut down the computer and wait five minutes for the internal components to cool down.
- 2 Unplug all cables from the computer except the power cord.
- 3 Turn the computer on its side on a soft, clean cloth, and ground yourself by touching the bare metal between the video ports.

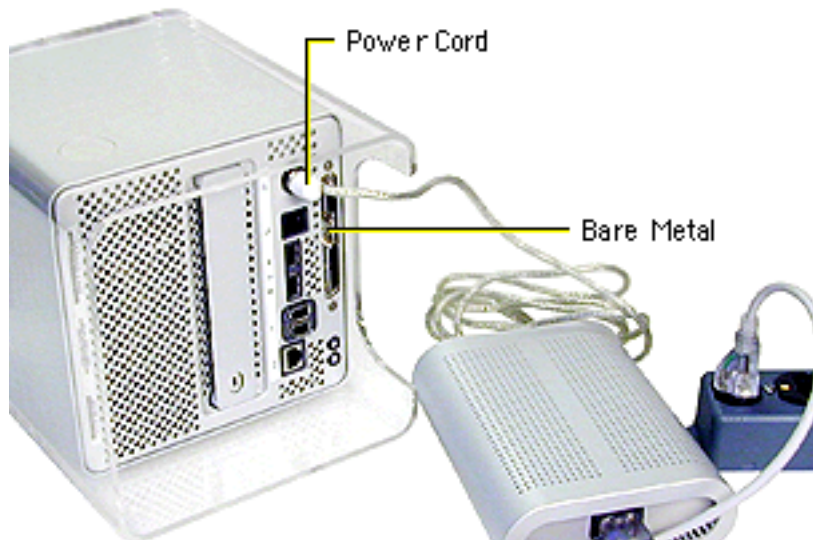

Important: To avoid electrostatic discharge, always ground yourself by touching the bare metal before you touch any parts or install any components inside the computer. To avoid static electricity building back up in your body, do not walk around the room until you have completed the installation and closed the computer.

- 4 Unplug the power cord.
- 5 Turn the computer upside down and push on the latch to release the lock. Allow the latch to extend completely.

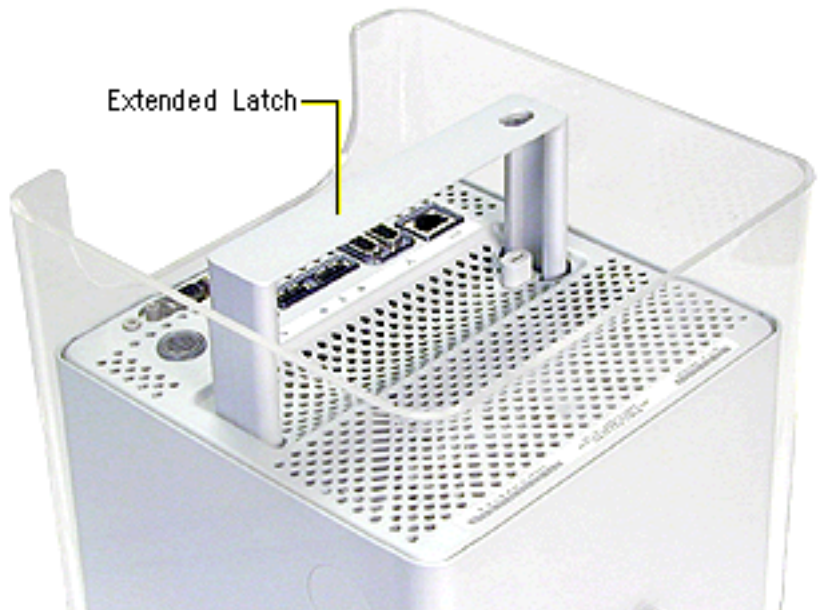

- 6 Gently pull up the core and place it on a soft cloth

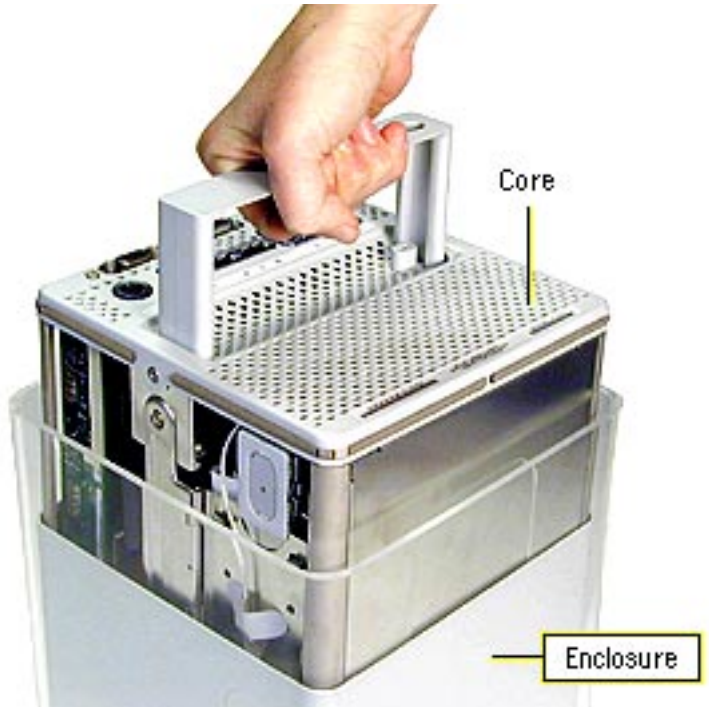

Removing the Top Plate Assembly

- 1 Press the latch in, and turn over the core so the power button faces up.
- 2 Remove the four corner screws that secure the top plate to the four vertical posts.
- 3 Remove the four screws on the two sides. (The two screws that align with the vertical plates are much longer than the other screws.)



- 4 Lift out the LED cover that is fitted over the power button LED. Set the LED cover aside for installation on the new top plate assembly.



- 5 Carefully lift up the top plate and disconnect the keyed connector (J1 on the logic board).

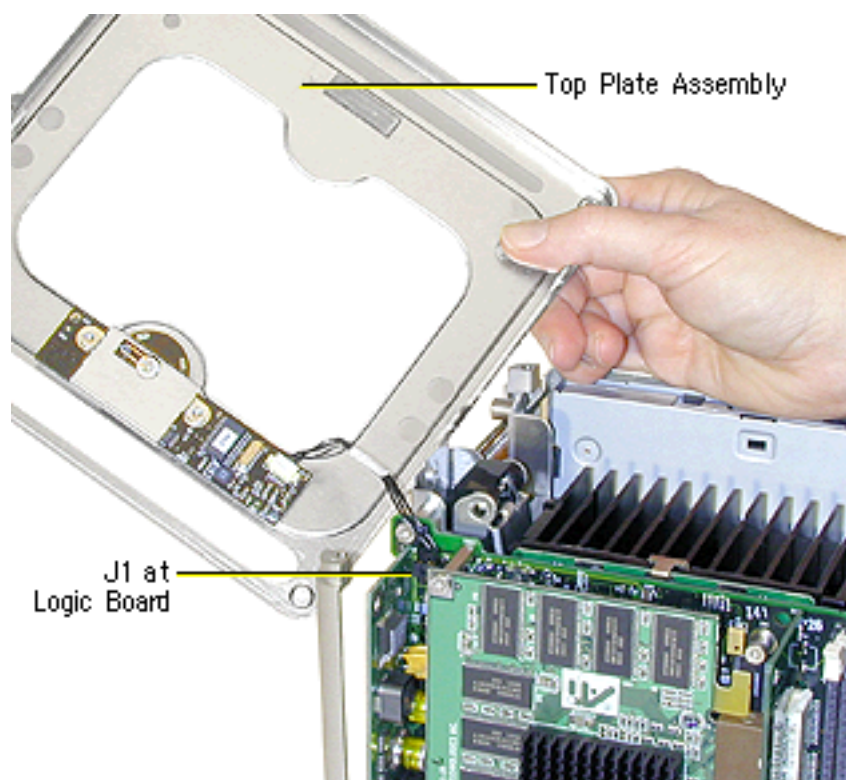

Installing the New Top Plate Assembly

- 1 With the replacement top plate assembly in hand, connect the cable from the top plate to the J1 connector on the logic board.

⚠ WARNING: To prevent damage to the power board, ensure the keyed connector fits into the J1 connector as shown.

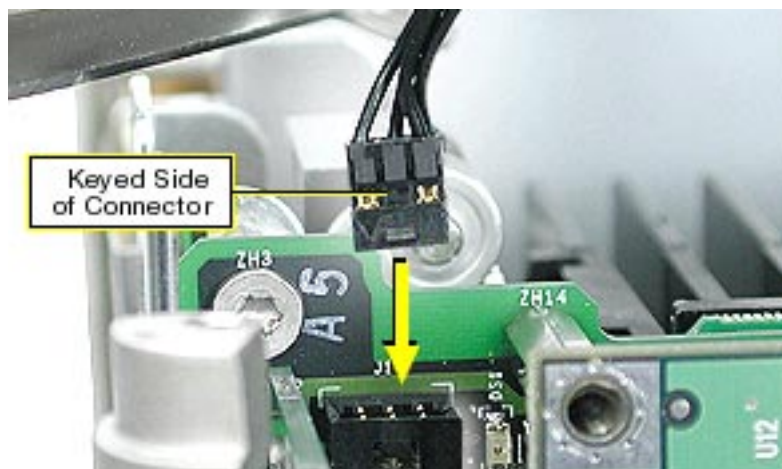

- 2 Install the LED cover over the power button LED on the replacement top plate assembly.
- 3 Position the top plate assembly over the core. Ensure that the four metal tabs align with the four slots in the top plate, and the DVD-ROM panel tucks in under the lip of the top plate.

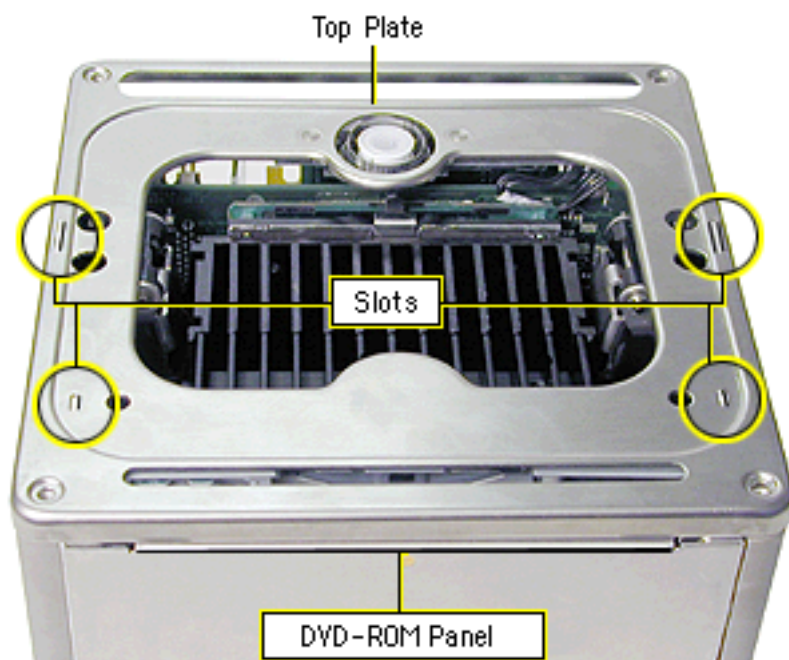

- 4 Starting with the four corner screws, secure the top plate to the core with all eight screws.

Replacing the Power Button Gasket in the Enclosure

Locate the power button gasket that came with the new top plate assembly. Install the gasket inside the enclosure as follows:

- 1 Place your hand in the enclosure and lift out the installed gasket.
- 2 Insert the new power button gasket into the recessed area that encircles the power button.
- 3 Press the gasket into place to ensure that it is secure.



Replacing the Computer Core in the Enclosure

- 1 Holding the core by the latch, insert the core into the enclosure. (The core fits only one way, with the ports toward the back of the computer.)
- 2 With a flat hand, press down on the latch until it locks into place. Firmly press the core to ensure it is fully secured within the enclosure.

Important: Do not lift or carry the computer by the core latch. The enclosure could fall off the core and be damaged.

- 3 Turn the computer upright and reconnect all cables.
- 4 Restart the computer.

⚠ WARNING: Never turn on the computer unless all of its internal and external parts are in place and it is closed. Operating the computer when it is open or missing parts can damage the computer or cause injury.

🍏 Apple Computer, Inc.

© 2001 Apple Computer, Inc. All rights reserved.

Under the copyright laws, this document may not be copied, in whole or in part, without the written consent of Apple.

The Apple logo is a trademark of Apple Computer, Inc., registered in the U.S. and other countries. Use of the “keyboard” Apple logo (Option-Shift-K) for commercial purposes without the prior written consent of Apple may constitute trademark infringement and unfair competition in violation of federal and state laws.

Every effort has been made to ensure that the information in this document is accurate. Apple is not responsible for printing or clerical errors.

Apple Computer, Inc.
1 Infinite Loop
Cupertino, CA 95014-2084
408-996-1010
<http://www.apple.com>

Apple, the Apple logo, Mac, Macintosh, and the Mac logo are trademarks of Apple Computer, Inc., registered in the U.S. and other countries.

Power Mac is a trademark of Apple Computer, Inc.

Video Riser Card Replacement Instructions

The following instructions explain how to replace the video riser card in the Power Mac G4 Cube.

Tools Required

The only tool required for this procedure is a Torx T-10 screwdriver.

Removing the Computer Core From the Enclosure

Warning: Always turn off the computer before opening it to avoid damaging its internal components.

- 1 Shut down the computer and wait five minutes for the internal components to cool down.
- 2 Unplug all cables from the computer except the power cord.
- 3 Turn the computer on its side on a soft, clean cloth, and ground yourself by touching the bare metal between the video ports.

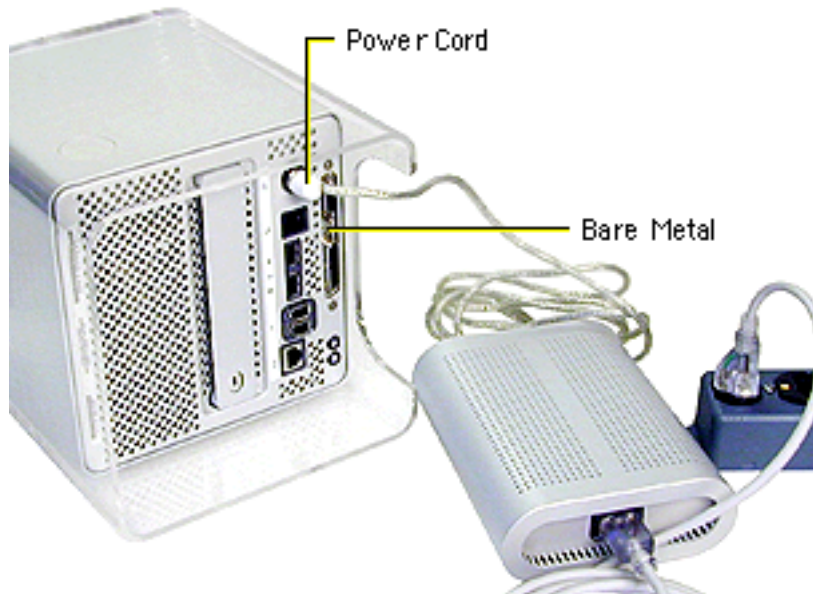

Important: To avoid electrostatic discharge, always ground yourself by touching the bare metal before you touch any parts or install any components inside the computer. To avoid static electricity building back up in your body, do not walk around the room until you have completed the installation and closed the computer.

- 4 Unplug the power cord.
- 5 Turn the computer upside down and push on the latch to release the lock. Allow the latch to extend completely.

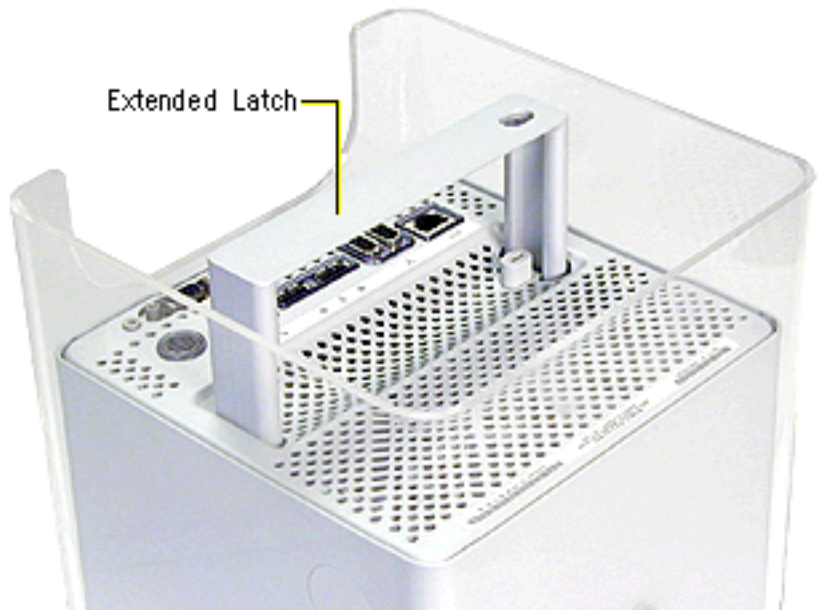

- 6 Gently pull up the core and place it on a soft cloth

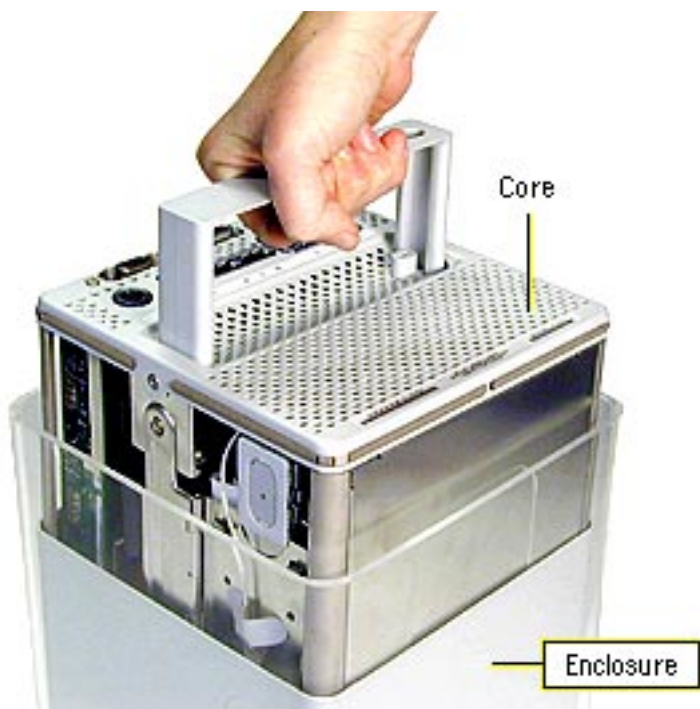

Removing the Video Riser Card

- 1 Place the core on its side so the core latch is in front of you.
- 2 Remove the two screws that secure the video card bracket to the chassis.
- 3 Remove the single screw located on the left corner of the video card.

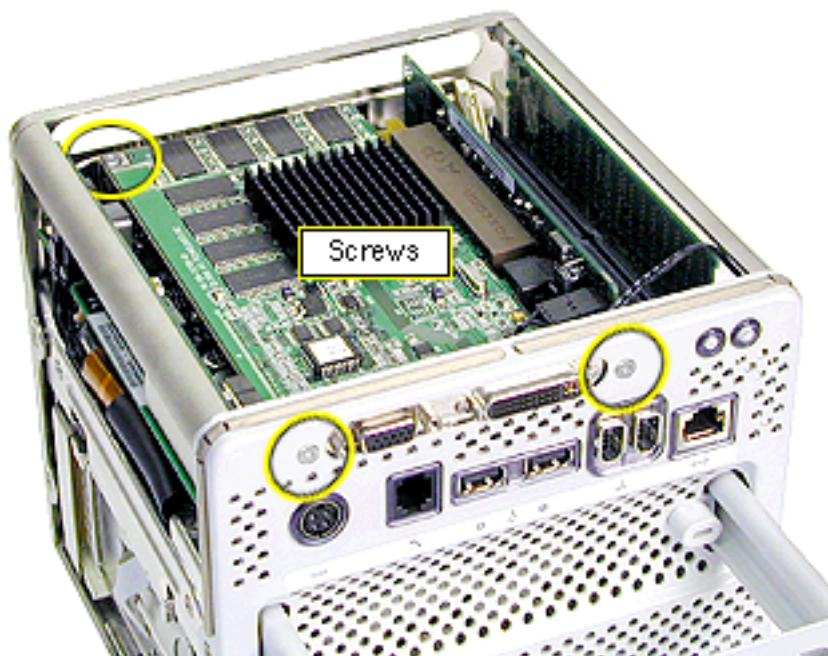

Note: If there is a metal clip on the corner of the video card, remove the screw from the clip, then lift off the clip. The metal clip is not present nor required on all production models.

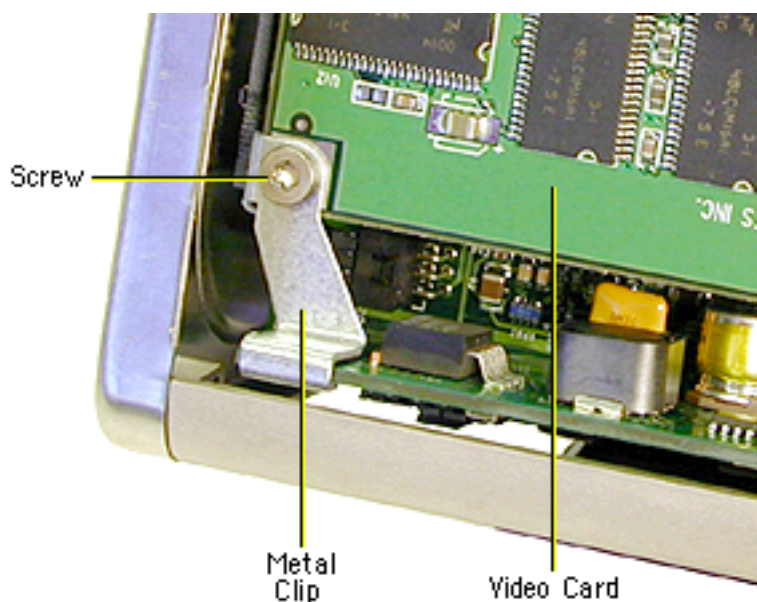

- 4 Warning:** When removing or installing a card, do not touch its gold connectors. Handle cards only by the edges.

Holding the video riser card by the top corners, gently rock and pull the card until it is released from its connector.

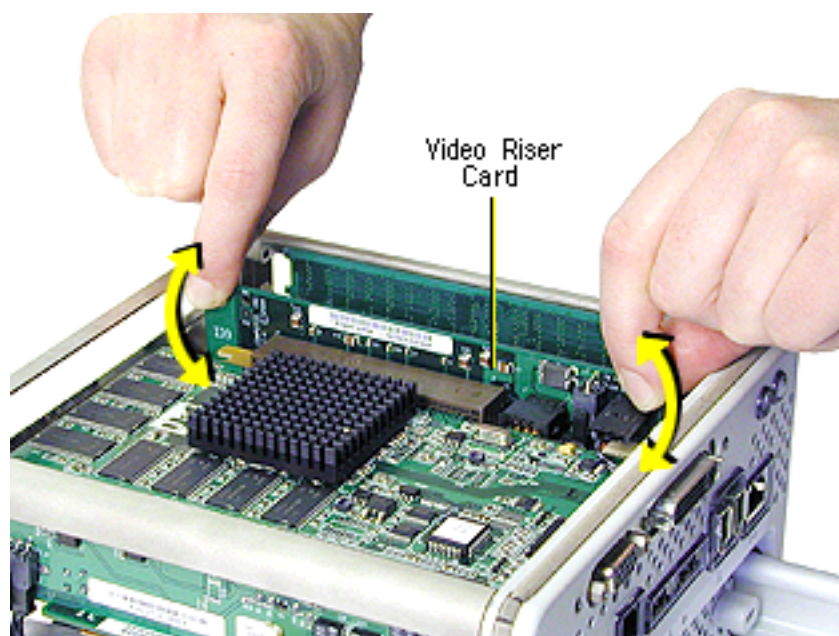

- 5 Holding the video riser card by the edges, tilt up the end of the video card (opposite the video ports), and slide the cards out of the chassis.

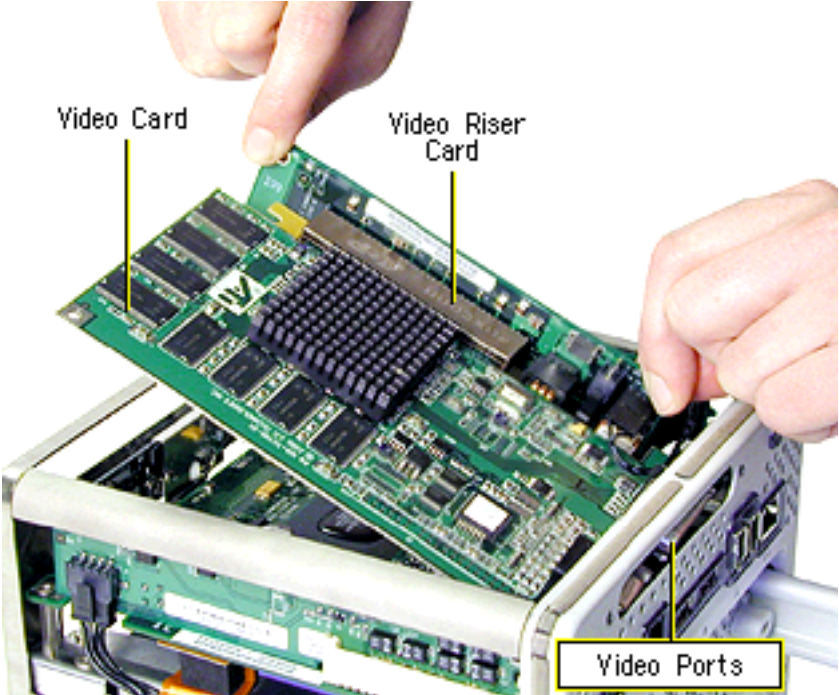

- 6 Turn over the video card. Holding the edge of the video card, disconnect it from the video riser card connector.

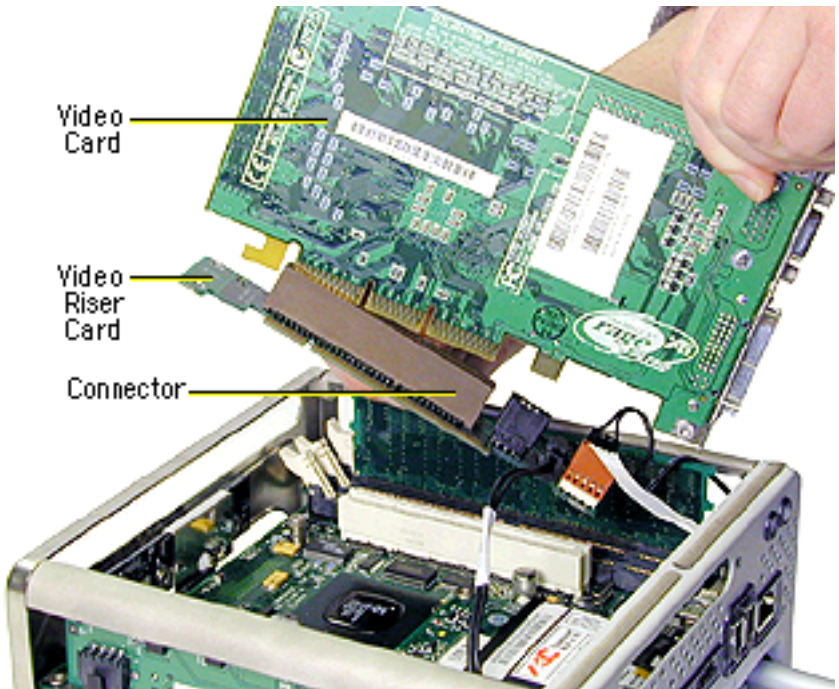

Note: On some production models, there is a green video-card connector clip on the video riser card. To disconnect the video card from the video-card connector clip, press the green tab to release the clip from the slot in the video card. Then disconnect the video card from the video riser card. The video-card connector clip is not present nor required on all production models.

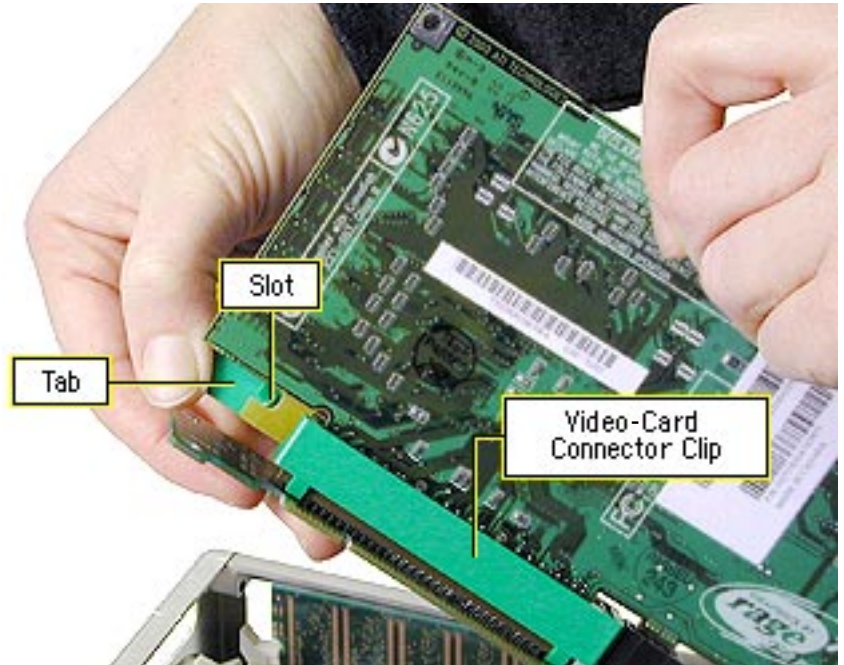

- 7 Disconnect the three video riser card connectors:
- J3 (2-pin connector, marked 28.5 V)
 - J4 (3-pin connector)
 - J6 (5-pin connector; fits tightly; rock back and forth to remove)

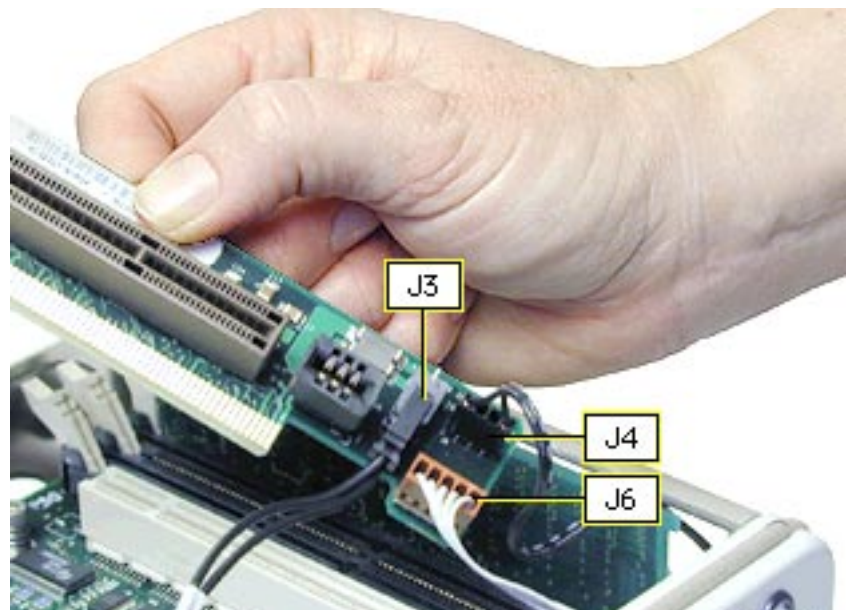

Installing the New Video Riser Card

- 1 Holding the replacement video riser card by the edges, reconnect connectors J3, J4, and J6.

Important: Ensure all cables are securely connected and tucked out of the way so they do not catch on the enclosure when replacing the computer core.

- 2 Connect the video card to the replacement video riser card. Firmly press the card into the connector until it snaps into place.
- 3 Tilt the video card into the chassis so the video ports align with the oval opening in the chassis.
- 4 Position the gold connectors on the video riser card over the card connector, and press the video riser card into place.
- 5 Install the three screws.

Replacing the Computer Core in the Enclosure

- 1 Holding the core by the latch, insert the core into the enclosure. (The core fits only one way, with the ports toward the back of the computer.)
- 2 With a flat hand, press down on the latch until it locks into place. Firmly press the core to ensure it is fully secured within the enclosure.

Important: Do not lift or carry the computer by the core latch. The enclosure could fall off the core and be damaged.

- 3 Turn the computer upright and reconnect all cables.
- 4 Restart the computer.

Warning: Never turn on the computer unless all of its internal and external parts are in place and it is closed. Operating the computer when it is open or missing parts can damage the computer or cause injury.

🍏 Apple Computer, Inc.

© 2000 Apple Computer, Inc. All rights reserved.

Under the copyright laws, this document may not be copied, in whole or in part, without the written consent of Apple.

The Apple logo is a trademark of Apple Computer, Inc., registered in the U.S. and other countries. Use of the “keyboard” Apple logo (Option-Shift-K) for commercial purposes without the prior written consent of Apple may constitute trademark infringement and unfair competition in violation of federal and state laws.

Every effort has been made to ensure that the information in this document is accurate. Apple is not responsible for printing or clerical errors.

Apple Computer, Inc.
1 Infinite Loop
Cupertino, CA 95014-2084
408-996-1010
<http://www.apple.com>

Apple, the Apple logo, Mac, Macintosh, and the Mac logo are trademarks of Apple Computer, Inc., registered in the U.S. and other countries.

Power Mac is a trademark of Apple Computer, Inc.

Video Card Replacement Instructions

The following instructions explain how to replace the video card in the Power Mac G4 Cube.

Tools Required

- Torx T-10 screwdriver
- Phillips screwdriver
- Pliers

Removing the Computer Core From the Enclosure

Warning: Always turn off the computer before opening it to avoid damaging its internal components.

- 1 Shut down the computer and wait five minutes for the internal components to cool down.
- 2 Unplug all cables from the computer except the power cord.
- 3 Turn the computer on its side on a soft, clean cloth, and ground yourself by touching the bare metal between the video ports.

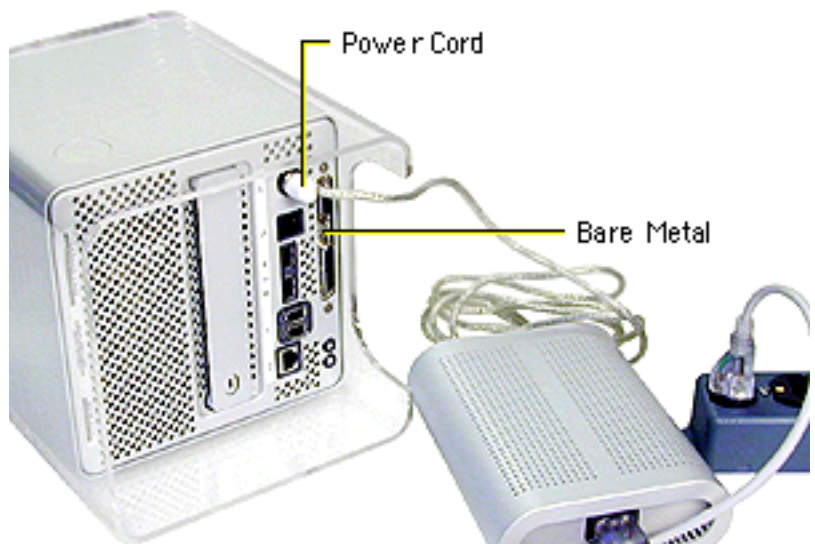

Important: To avoid electrostatic discharge, always ground yourself by touching the bare metal before you touch any parts or install any components inside the computer. To avoid static electricity building back up in your body, do not walk around the room until you have completed the installation and closed the computer.

- 4 Unplug the power cord.
- 5 Turn the computer upside down and push on the latch to release the lock. Allow the latch to extend completely.

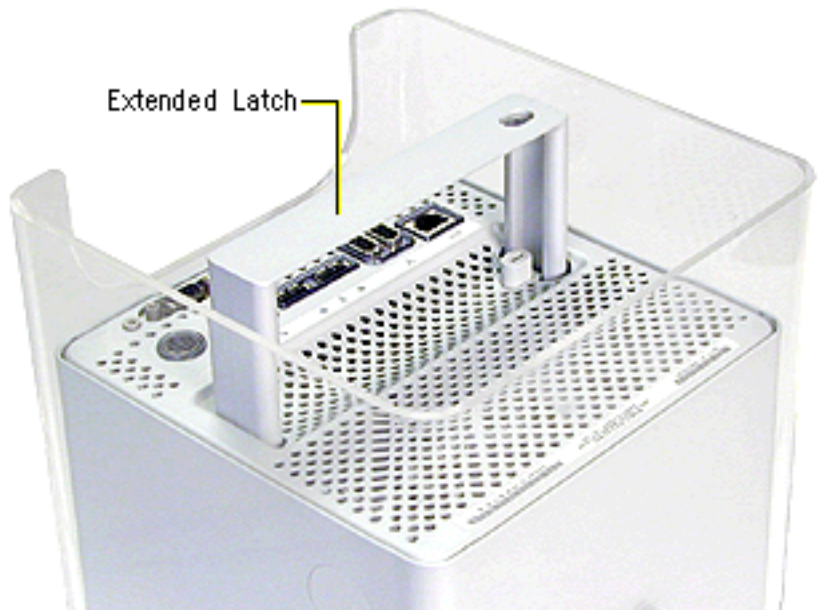

- 6 Gently pull up the core and place it on a soft cloth

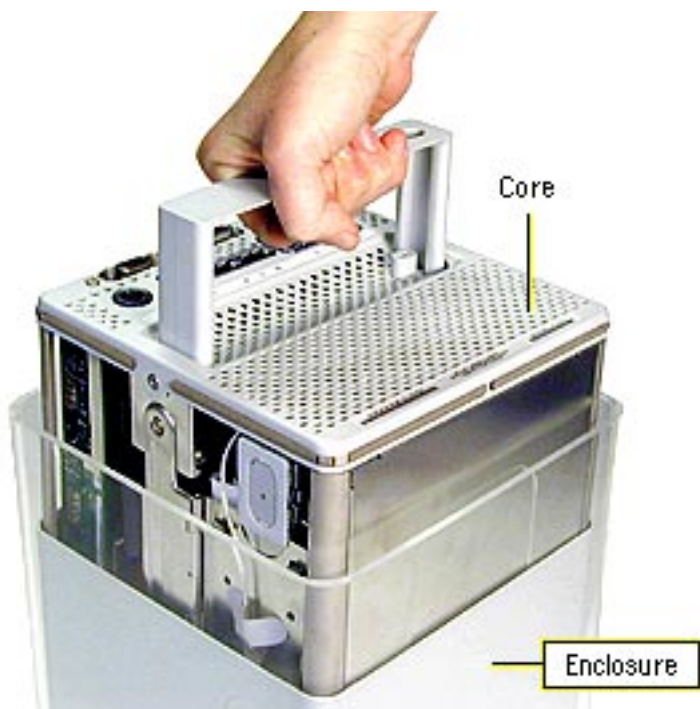

Removing the Video Card

- 1 Place the core on its side so the core latch is in front of you.
- 2 Remove the two screws that secure the video card bracket to the chassis.
- 3 Remove the single screw located on the left corner of the video card.

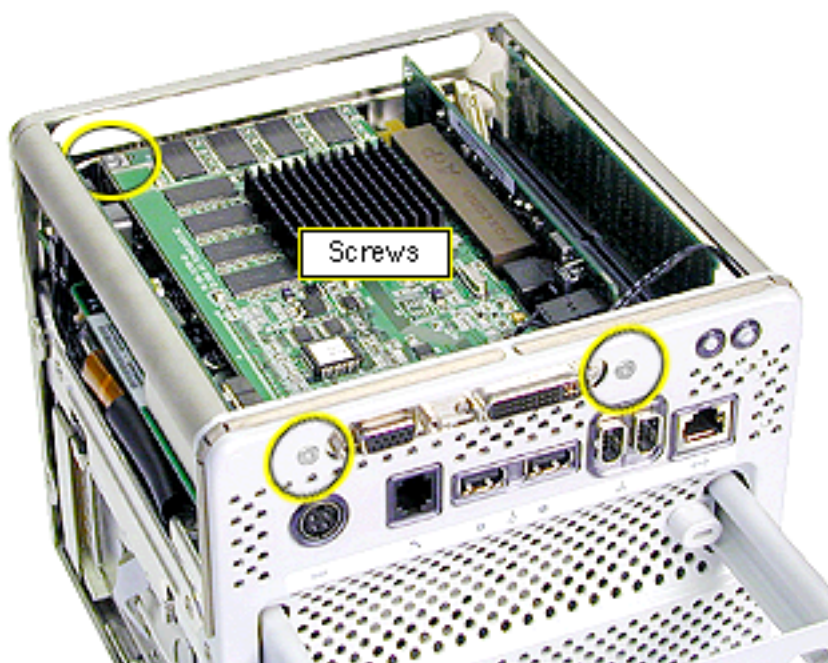

Note: If there is a metal clip on the corner of the video card, remove the screw from the clip, then lift off the clip. The metal clip is not present nor required on all production models.

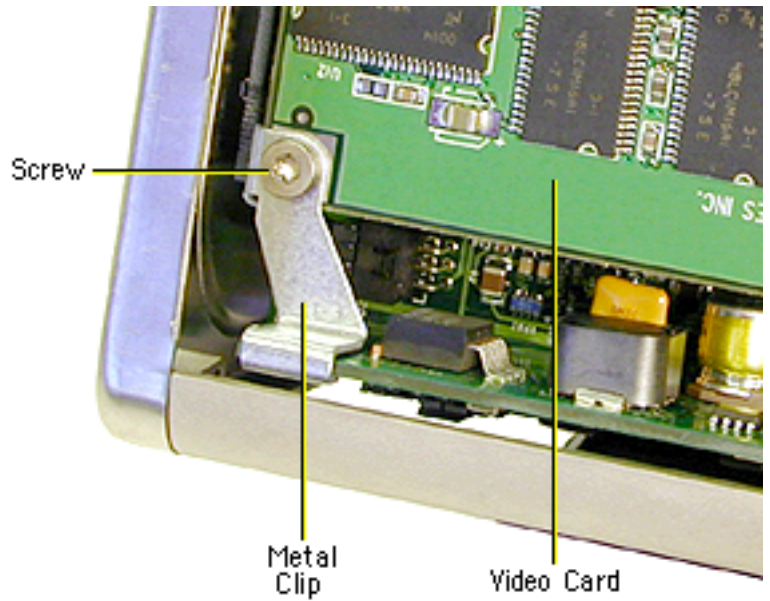

- 4 **Warning:** When removing or installing a card, do not touch its gold connectors. Handle cards only by the edges.

Holding the video riser card by the top corners, gently rock and pull the card until it is released from its connector.

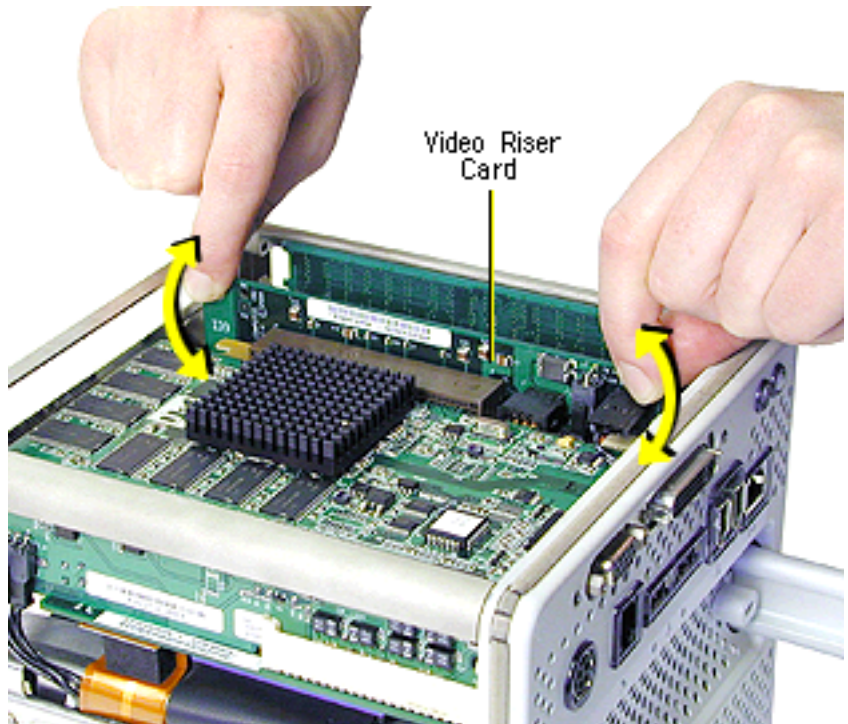

- 5 Holding the video riser card by the edges, tilt up the end of the video card (opposite the video ports), and slide the cards out of the chassis.

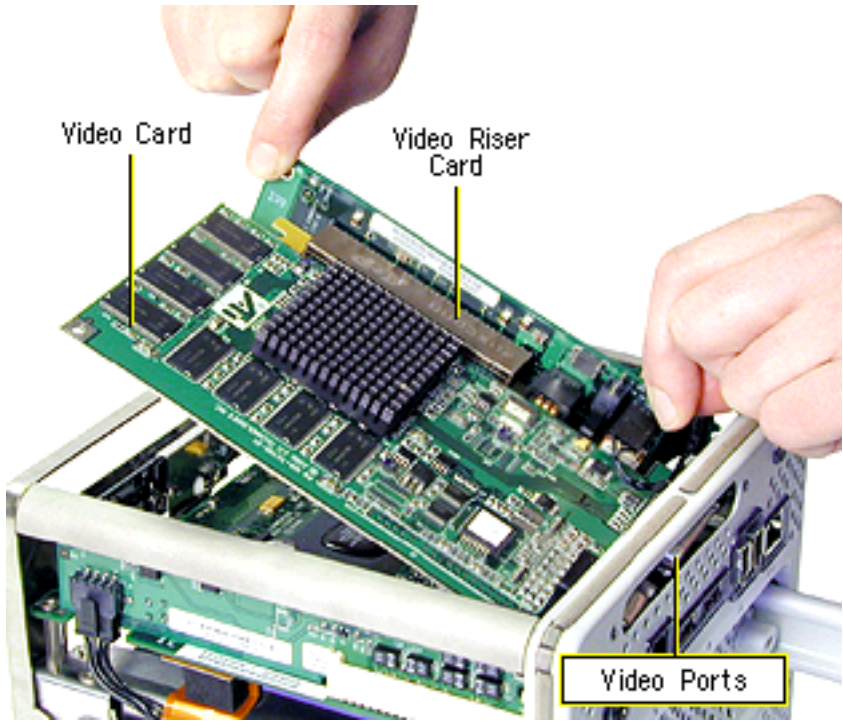

- 6 Turn over the video card. Holding the edge of the video card, disconnect it from the video riser card connector.

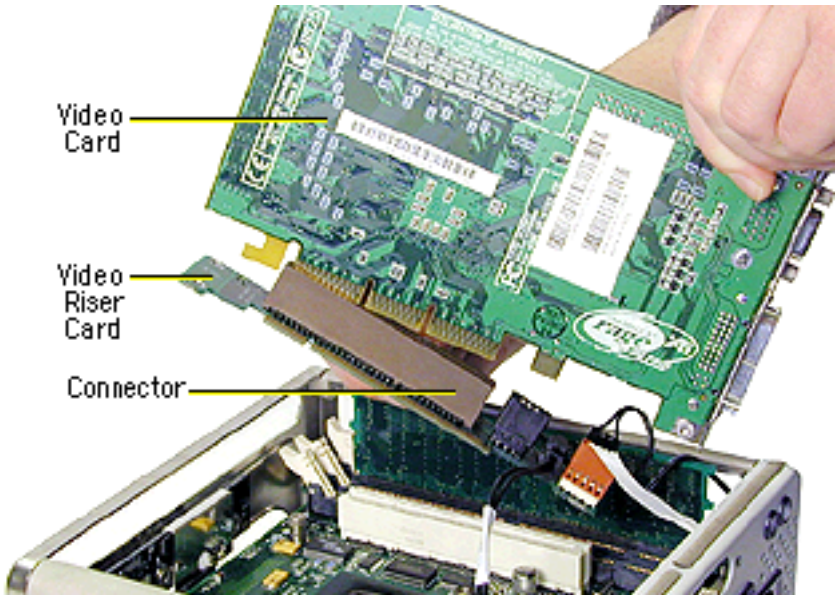

Installing the New Video Card

- 1 Remove the replacement video card from its static-proof bag and hold it by its corners, taking care not to touch the gold connector or any of the components on the card.
- 2 If the replacement card does not have a fence already installed, install the fence that came in the box with the card. Using a Phillips screwdriver, install the two Phillips screws on either side of the ADC connector and the two Torx screws on the fence side tabs. Using pliers, install the two jack-nut screws on either side of the VGA connector.

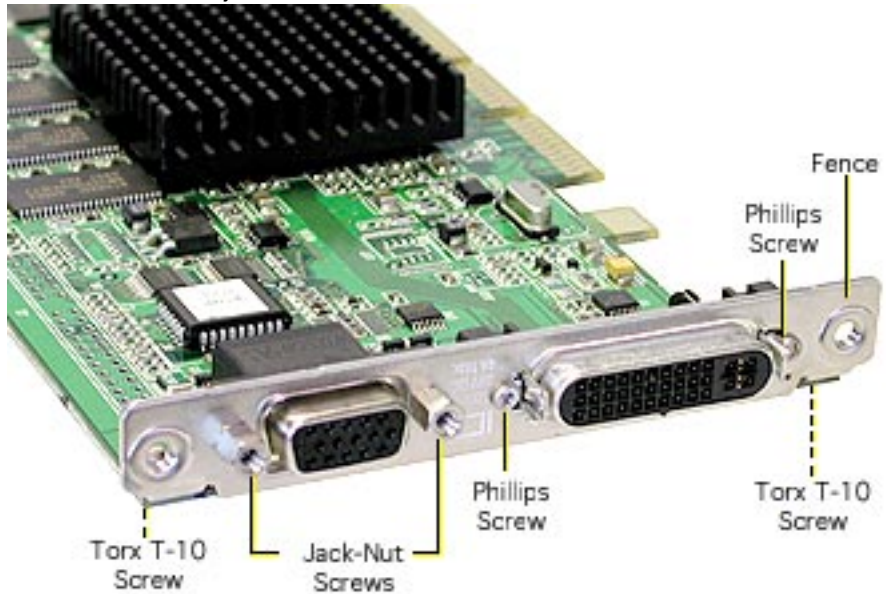

- 3 Connect the replacement video card to the video riser card. Firmly press the card into the connector until it snaps into place.
- 4 Tilt the video card into the chassis so the video ports align with the oval opening in the chassis.
- 5 Position the gold connectors on the video riser card over the card connector, and press the video riser card into place.
- 6 Install the three screws.

Replacing the Computer Core in the Enclosure

- 1 Holding the core by the latch, insert the core into the enclosure. (The core fits only one way, with the ports toward the back of the computer.)
- 2 With a flat hand, press down on the latch until it locks into place. Firmly press the core to ensure it is fully secured within the enclosure.

Important: Do not lift or carry the computer by the core latch. The enclosure could fall off the core and be damaged.

- 3 Turn the computer upright and reconnect all cables.
- 4 Restart the computer.

Warning: Never turn on the computer unless all of its internal and external parts are in place and it is closed. Operating the computer when it is open or missing parts can damage the computer or cause injury.

🍏 Apple Computer, Inc.

© 2001 Apple Computer, Inc. All rights reserved.

Under the copyright laws, this document may not be copied, in whole or in part, without the written consent of Apple.

The Apple logo is a trademark of Apple Computer, Inc., registered in the U.S. and other countries. Use of the “keyboard” Apple logo (Option-Shift-K) for commercial purposes without the prior written consent of Apple may constitute trademark infringement and unfair competition in violation of federal and state laws.

Every effort has been made to ensure that the information in this document is accurate. Apple is not responsible for printing or clerical errors.

Apple Computer, Inc.
1 Infinite Loop
Cupertino, CA 95014-2084
408-996-1010
<http://www.apple.com>

Apple, the Apple logo, Mac, Macintosh, and the Mac logo are trademarks of Apple Computer, Inc., registered in the U.S. and other countries.

Power Mac is a trademark of Apple Computer, Inc.

Modem Board Replacement Instructions

The following instructions explain how to replace the modem board in the Power Mac G4 Cube.

Tools Required

The only tool required for this procedure is a Torx T-10 screwdriver.

Removing the Computer Core From the Enclosure

Warning: Always turn off the computer before opening it to avoid damaging its internal components.

- 1 Shut down the computer and wait five minutes for the internal components to cool down.
- 2 Unplug all cables from the computer except the power cord.
- 3 Turn the computer on its side on a soft, clean cloth, and ground yourself by touching the bare metal between the video ports.

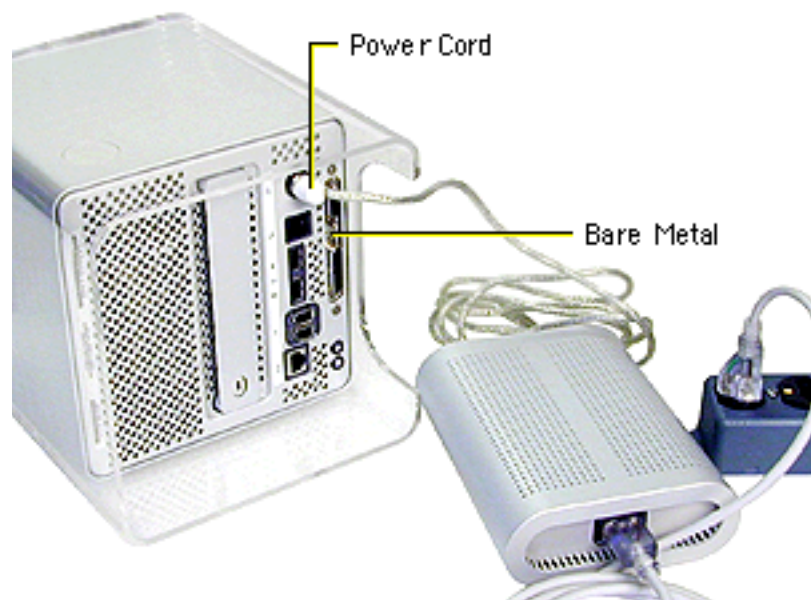

Important: To avoid electrostatic discharge, always ground yourself by touching the bare metal before you touch any parts or install any components inside the computer. To avoid static electricity building back up in your body, do not walk around the room until you have completed the installation and closed the computer.

- 4 Unplug the power cord.
- 5 Turn the computer upside down and push on the latch to release the lock. Allow the latch to extend completely.

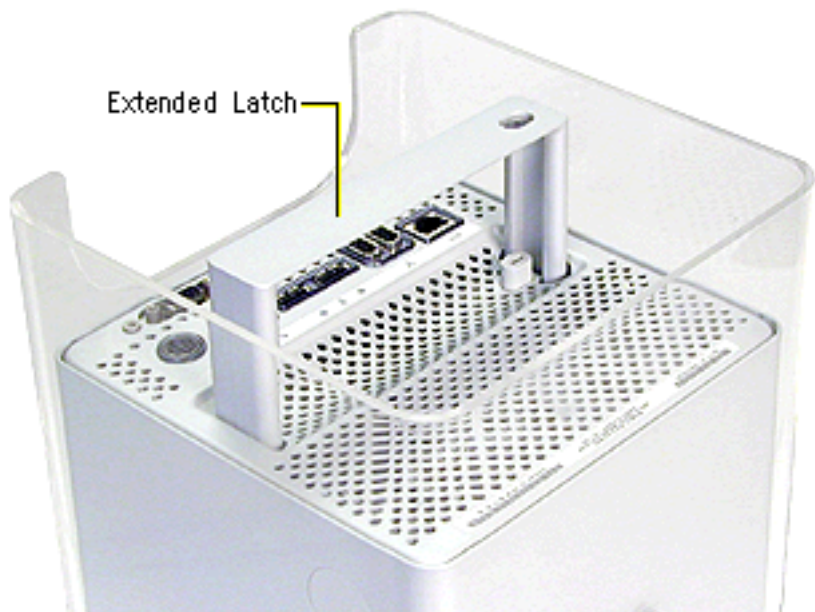

- 6 Gently pull up the core and place it on a soft cloth

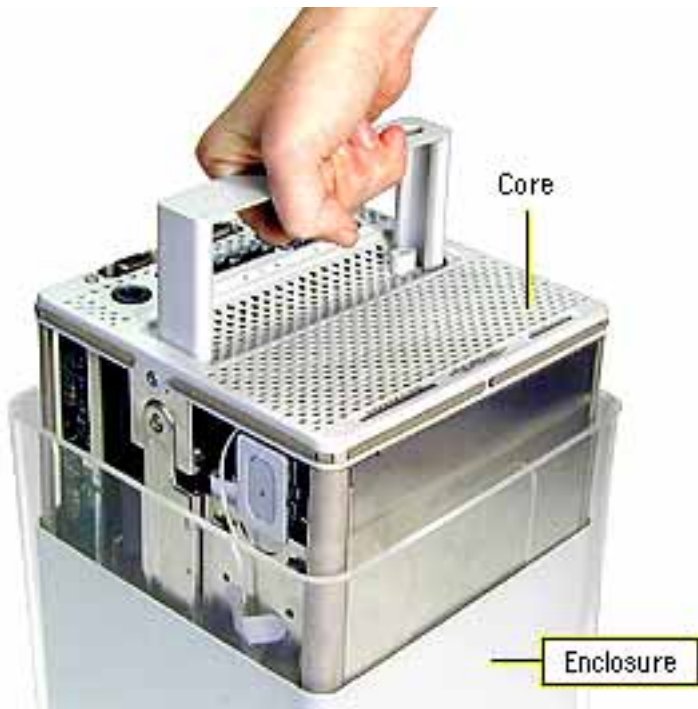

Removing the Modem Board

- 1 Place the core on its side so the core latch is in front of you.
- 2 Remove the two screws that secure the video card bracket to the chassis.
- 3 Remove the single screw located on the left corner of the video card.

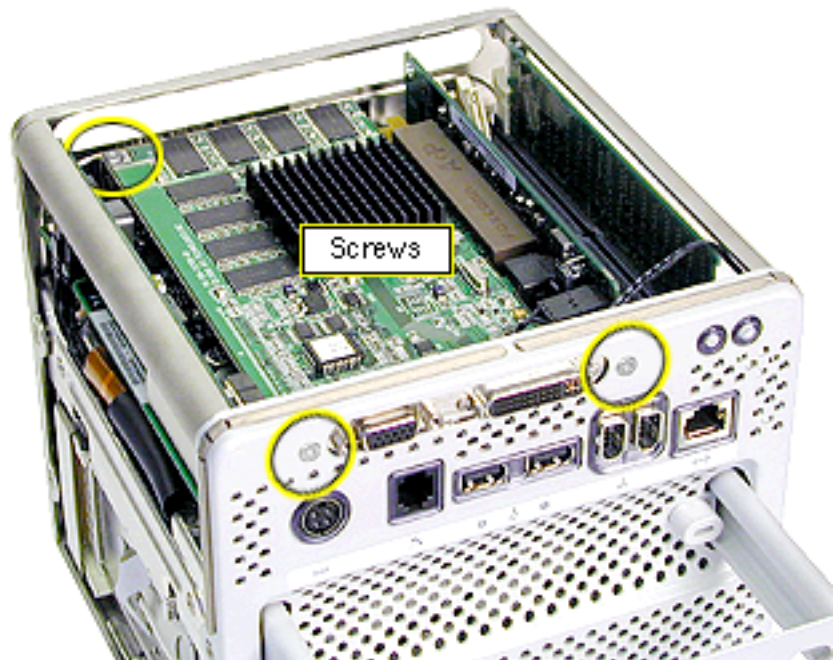

Note: If there is a metal clip on the corner of the card, remove the screw from the clip, then lift off the clip. The metal clip is not present nor required on all production models.

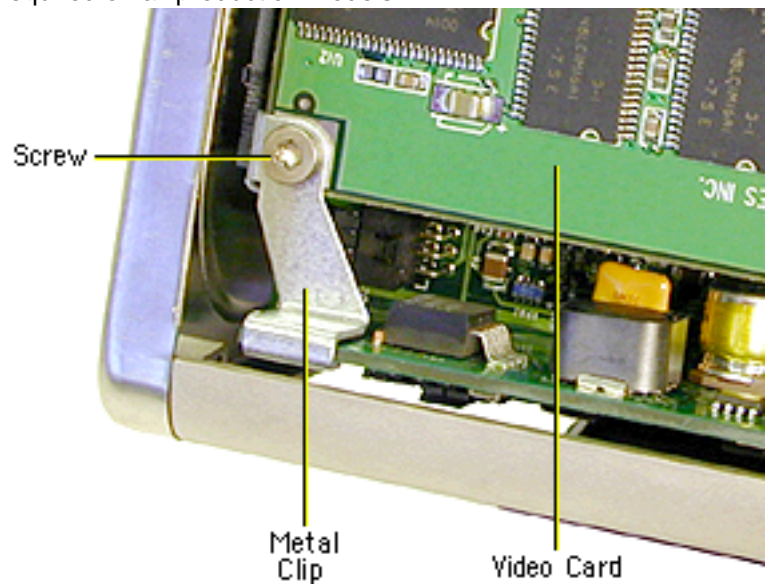

- 4 Holding the video riser card by the top corners, gently rock and pull the card until it is released from its connector

Warning: When removing or installing a card, do not touch its gold connectors. Handle cards only by the edges.

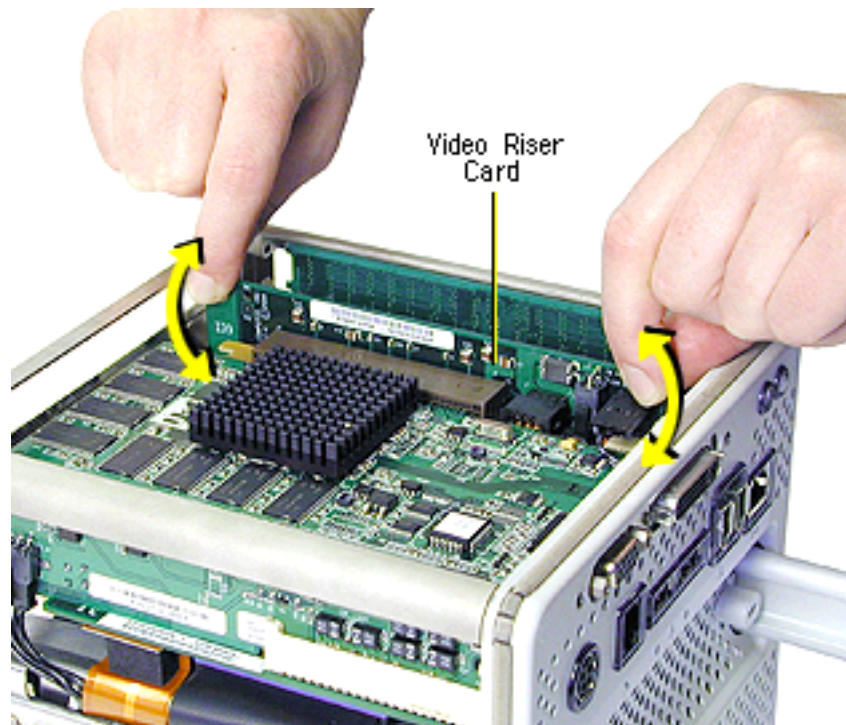

- 5 Holding the video riser card by the edges, tilt up the end of the video card (opposite the video ports), and slide the cards out of the chassis.

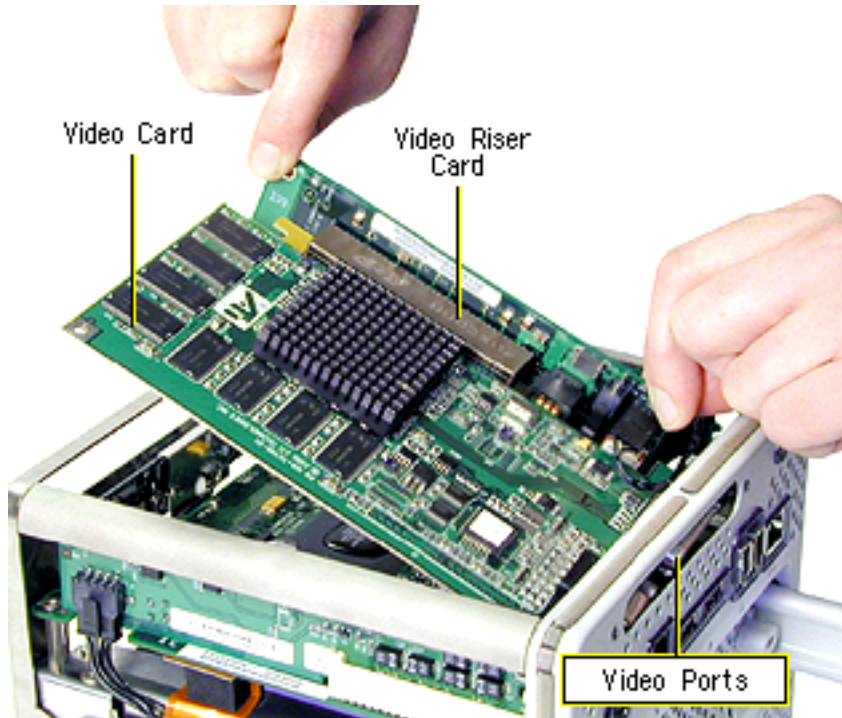

- 6 Turn over the video card. Holding the edge of the video card, disconnect connector J3 (2-pin; marked 28.5 V) from the video riser card.

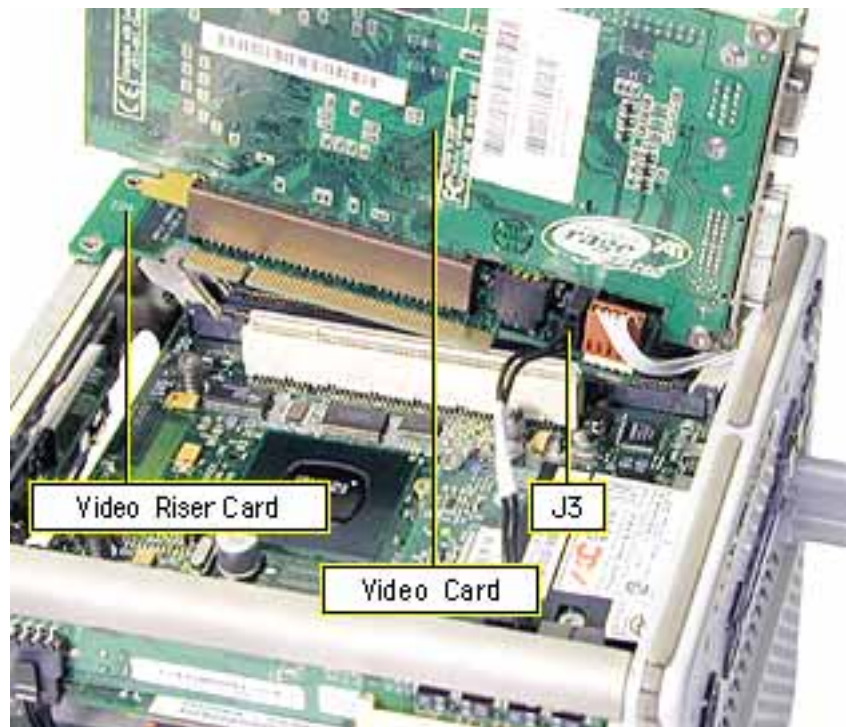

- 7 Remove the two screws at the modem board. (The modem screws are shorter than the video card screws.)

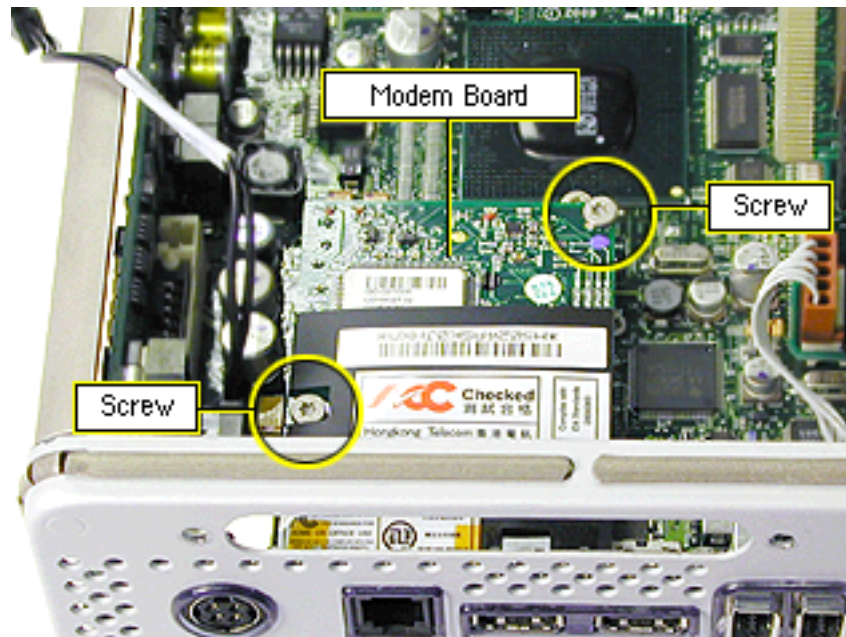

- 8 Holding the modem board by the edges, rock and tilt it up to release it from its connector. Then move it away from the chassis panel to release the modem port.

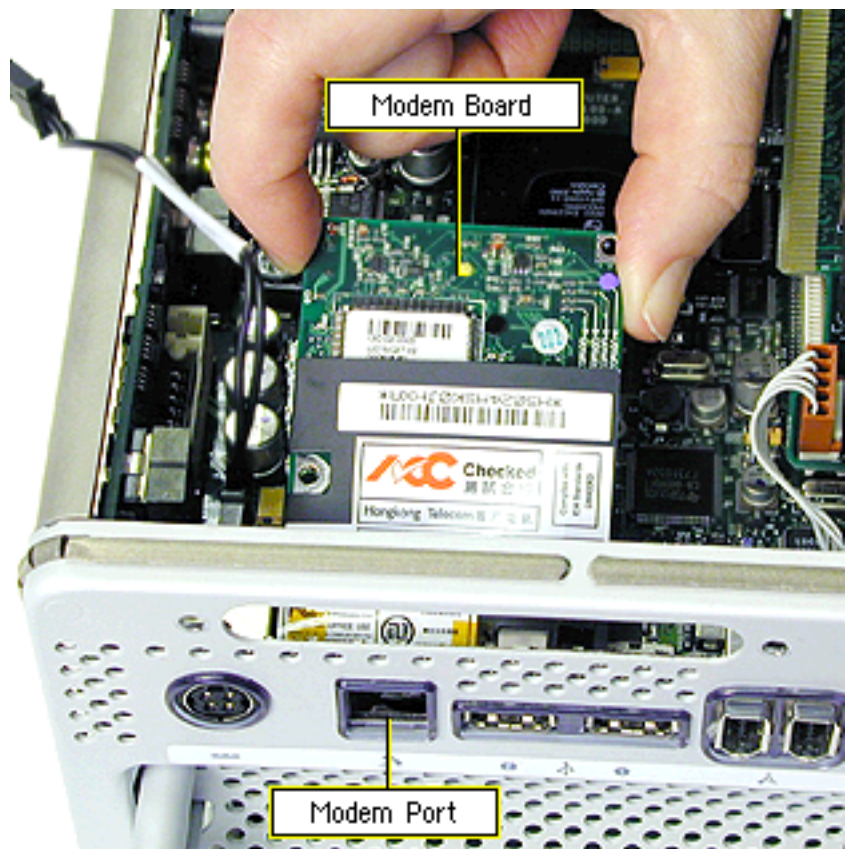

Installing the New Modem Board

- 1 Holding the replacement modem board by the edges, tilt the board so the modem port fits into the opening in the chassis.
- 2 With the modem board aligned over the connector, press the edges of the board so the modem board snaps into place.
- 3 Install the two screws.
- 4 Connect video riser card connector J3.

Important: Ensure all cables are securely connected and tucked out of the way so they do not catch on the enclosure when replacing the computer core.

- 5 Connect the video card to the video riser card. Firmly press the card into the connector until it snaps into place.
- 6 Tilt the video card into the chassis so the video ports align with the oval opening in the chassis.
- 7 Position the gold connectors on the video riser card over the card connector, and press the video riser card into place.
- 8 Install the three screws.

Replacing the Computer Core in the Enclosure

- 1 Holding the core by the latch, insert the core into the enclosure. (The core fits only one way, with the ports toward the back of the computer.)
- 2 With a flat hand, press down on the latch until it locks into place. Firmly press the core to ensure it is fully secured within the enclosure.

Important: Do not lift or carry the computer by the core latch. The enclosure could fall off the core and be damaged.

- 3 Turn the computer upright and reconnect all cables.
- 4 Restart the computer.

Warning: Never turn on the computer unless all of its internal and external parts are in place and it is closed. Operating the computer when it is open or missing parts can damage the computer or cause injury.

Note: After you have replaced a modem in Europe or Asia, open the software utility Modem Country Selector and verify that the modem is set to the correct country. Modem Country Selector is located in the Apple Extras folder on your hard drive or can be downloaded as part of the Apple Modem Updater software bundle at <http://www.apple.com/software>.

🍏 Apple Computer, Inc.

© 2001 Apple Computer, Inc. All rights reserved.

Under the copyright laws, this document may not be copied, in whole or in part, without the written consent of Apple.

The Apple logo is a trademark of Apple Computer, Inc., registered in the U.S. and other countries. Use of the “keyboard” Apple logo (Option-Shift-K) for commercial purposes without the prior written consent of Apple may constitute trademark infringement and unfair competition in violation of federal and state laws.

Every effort has been made to ensure that the information in this document is accurate. Apple is not responsible for printing or clerical errors.

Apple Computer, Inc.
1 Infinite Loop
Cupertino, CA 95014-2084
408-996-1010
<http://www.apple.com>

Apple, the Apple logo, Mac, Macintosh, and the Mac logo are trademarks of Apple Computer, Inc., registered in the U.S. and other countries.

Power Mac is a trademark of Apple Computer, Inc.

CD/DVD-ROM Drive Replacement Instructions

The following instructions explain how to replace the CD/DVD-ROM optical drive in the Power Mac G4 Cube computer.

Tools Required

- Torx T10 screwdriver
- Magnetized Phillips screwdriver
- Pliers
- Jeweler's Phillips screwdriver

Removing the Computer Core From the Enclosure

⚠ WARNING: Always turn off the computer before opening it to avoid damaging its internal components.

- 1 Shut down the computer and wait five minutes for the internal components to cool down.
- 2 Unplug all cables from the computer except the power cord.
- 3 Turn the computer on its side on a soft, clean cloth, and ground yourself by touching the bare metal between the video ports.

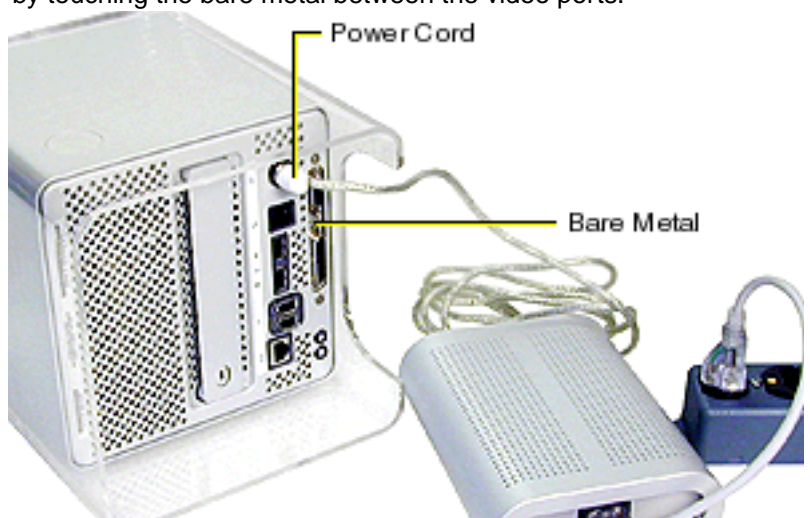

Important: To avoid electrostatic discharge, always ground yourself by touching the bare metal before you touch any parts or install any components inside the computer. To avoid static electricity building back up in your body, do not walk around the room until you have completed the installation and closed the computer.

- 4 Unplug the power cord.
- 5 Turn the computer upside down and push on the latch to release the lock. Allow the latch to extend completely.

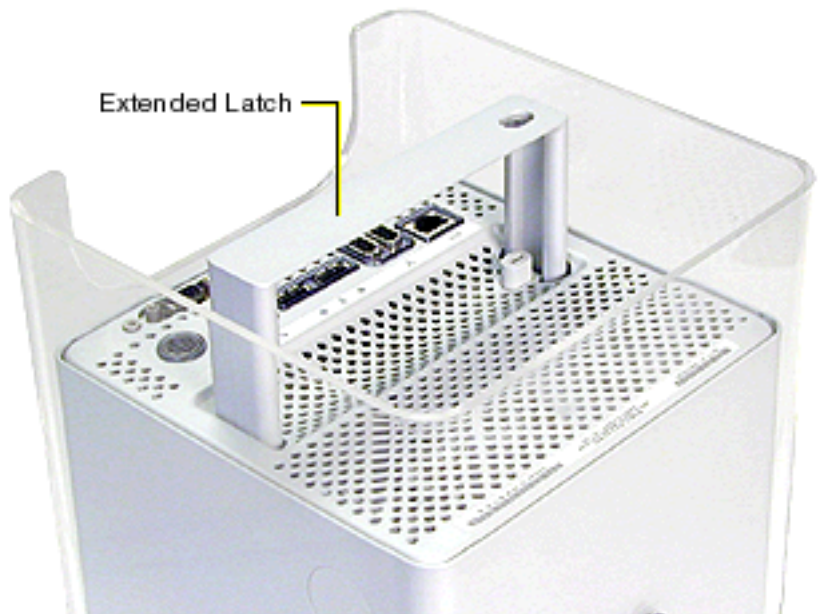

- 6 Gently pull up the core and place it on a soft cloth



Removing the Top Plate Assembly

- 1 Press the latch in, and turn over the core so the power button faces up.
- 2 Remove the four corner screws that secure the top plate to the four vertical posts.
- 3 Remove the four screws on the two sides. (The two screws that align with the vertical plates are much longer than the other screws.)



- 4 Carefully lift up the top plate and disconnect the keyed connector (J1 on the logic board).

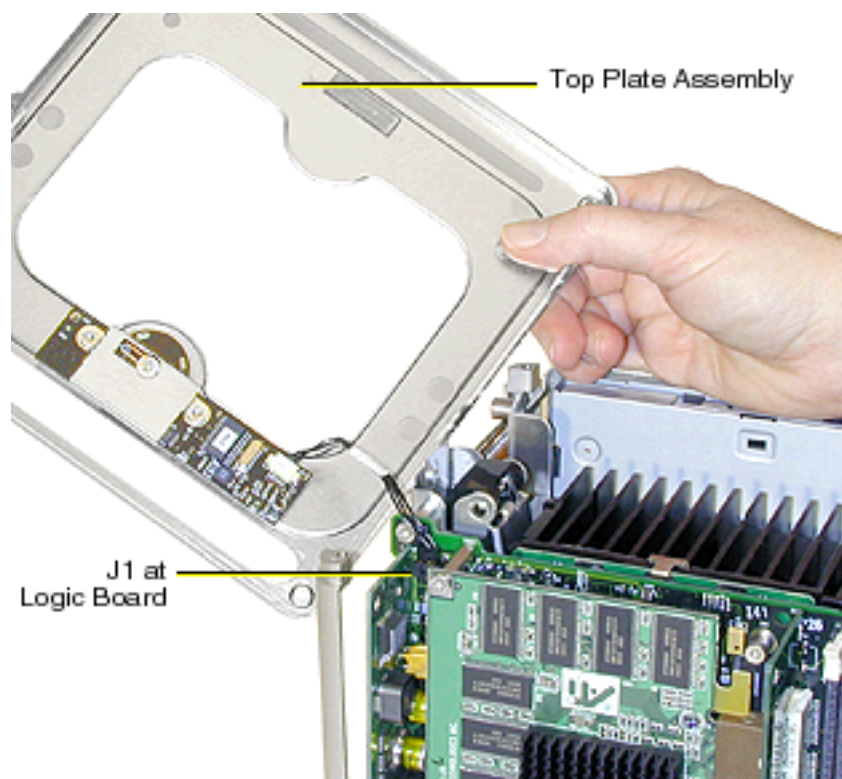

Removing the CD/DVD-ROM Drive

- 1 Grasp the top of the side panel, and slide it up and away to clear the four tabs on the inner side of the panel.

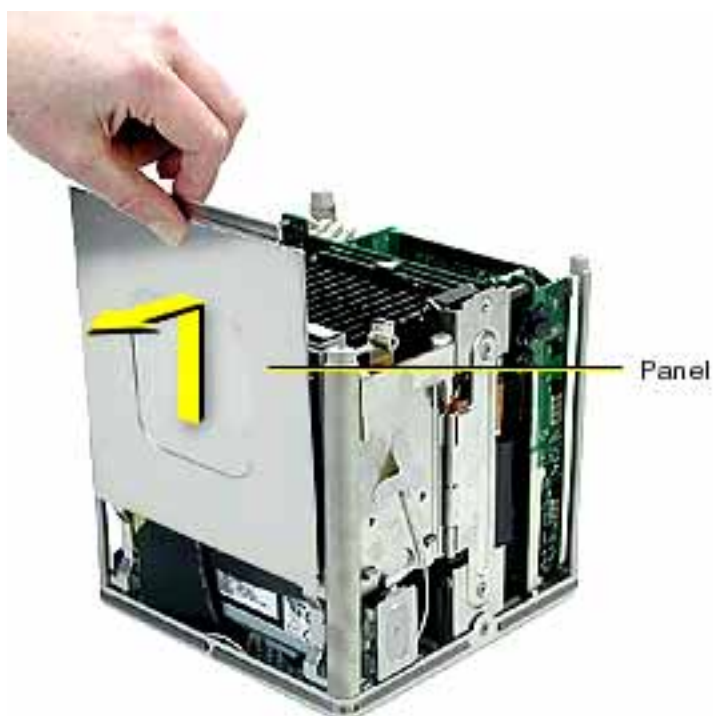

- 2 Move the AirPort Card antenna cable out from under the tape. If an AirPort Card is installed, disconnect the antenna cable from the AirPort Card. Press in on the latch to open the door

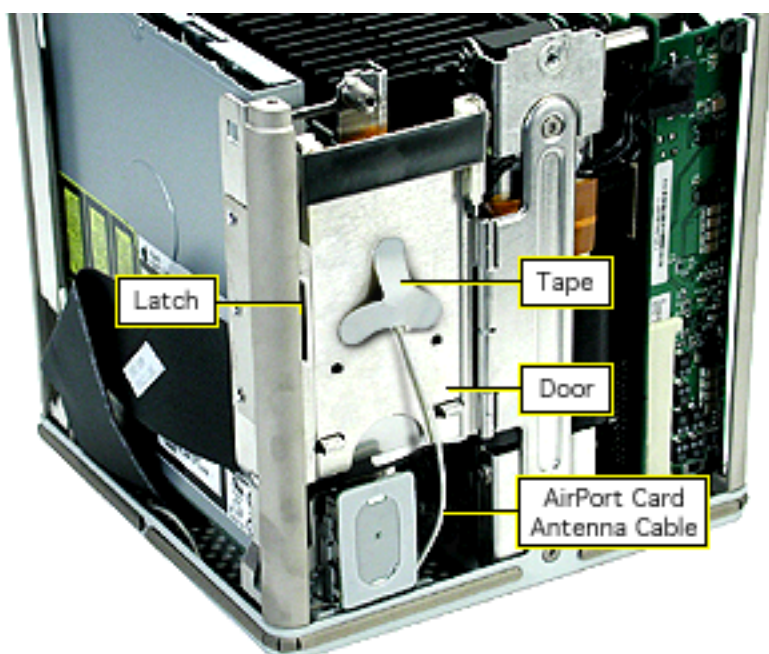

- 3 Using a magnetized screwdriver, remove the two screws from the side of the drive. Repeat on the other side.

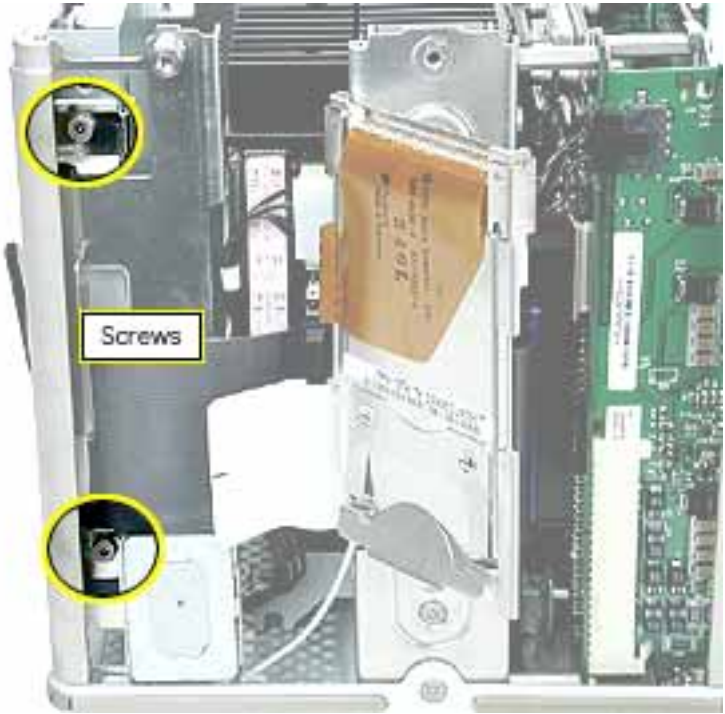

- 4 **⚠ WARNING:** If the optical drive case is squeezed too tightly, the laser lens could be damaged. When handling the drive case, touch only the outer edges of the case.

Holding the drive case by the corner, pull the drive up about half way and disconnect the ATA ribbon cable. Then, using pliers, grasp the power cable connector and pull it toward you to disconnect it.

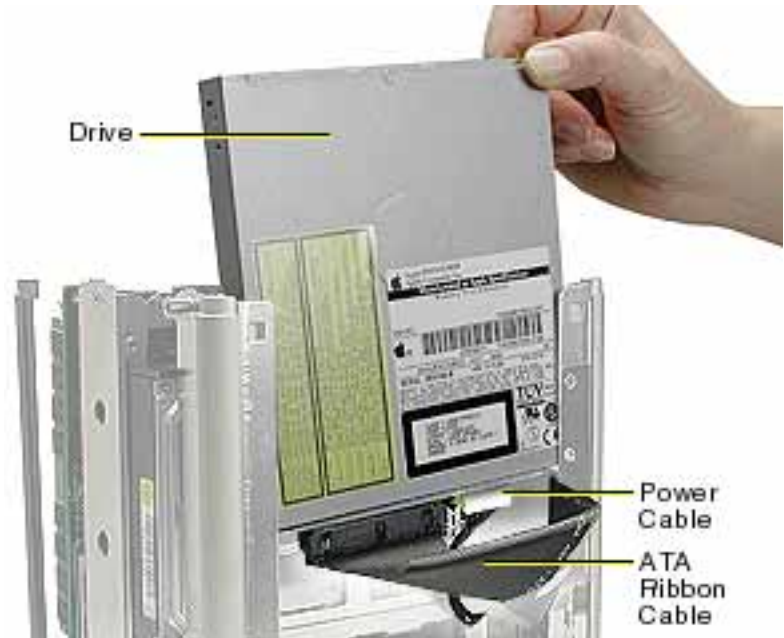

- 5 Slide the optical drive up and out of the chassis.
- 6 Disconnect the board from the drive by removing the two screws. Then pull the board off of the drive. Place the board aside for assembly on the replacement optical drive.

⚠ WARNING: If the optical drive case is squeezed too tightly, the laser lens could be damaged. When handling the drive case, touch only the outer edges of the case.

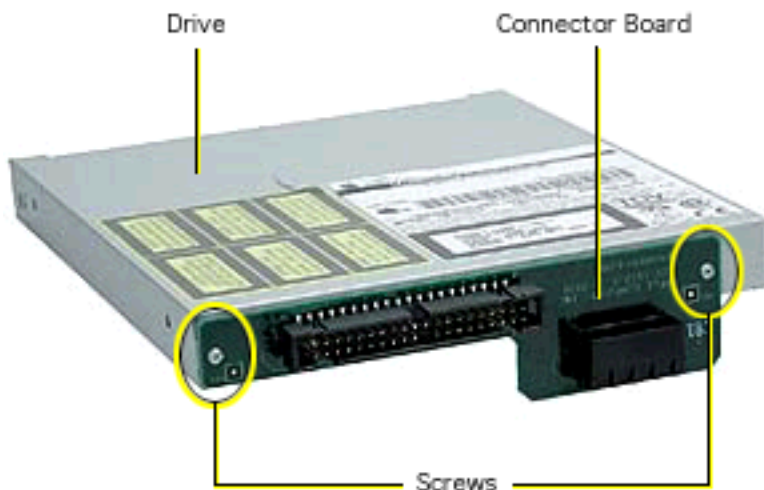

Installing the Replacement CD/DVD-ROM Drive

- 1 Ensure the replacement optical drive switch is set to "Slave."

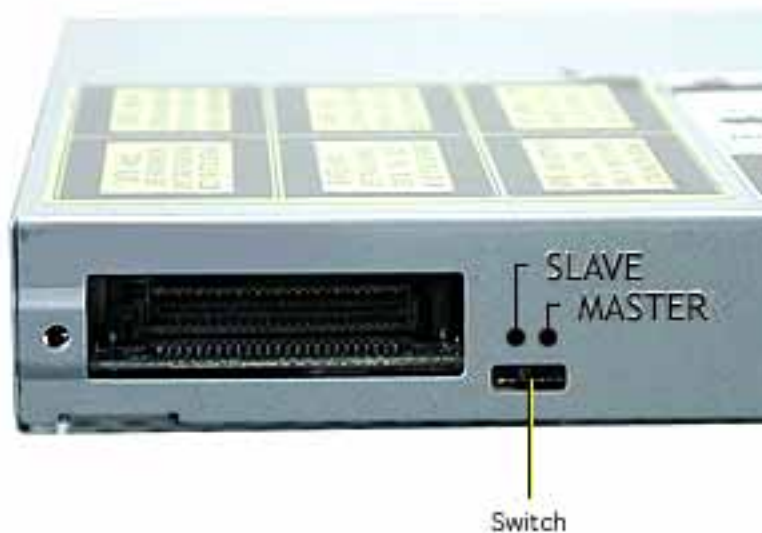

- 2 Install the connector board on the replacement optical drive, and secure it to the drive with the two screws.

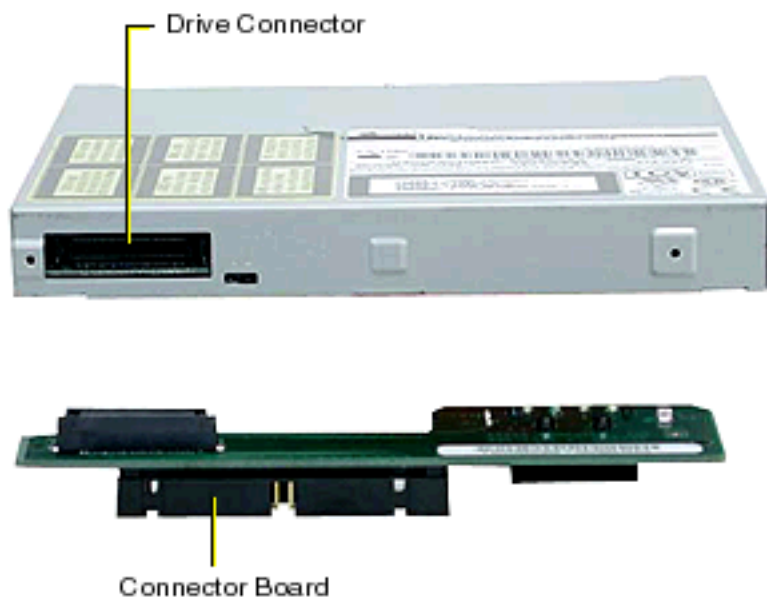

- 3 Holding the optical drive case by one corner, position the drive over the chassis so the labeled panel faces out and the connector board is at the bottom of the drive case. Slide in the drive half way and connect the power cable and the ATA ribbon cable.
- 4 Slide the drive all the way down and ensure the screw holes align on both sides of the drive. If they do not align, reseal the connectors.

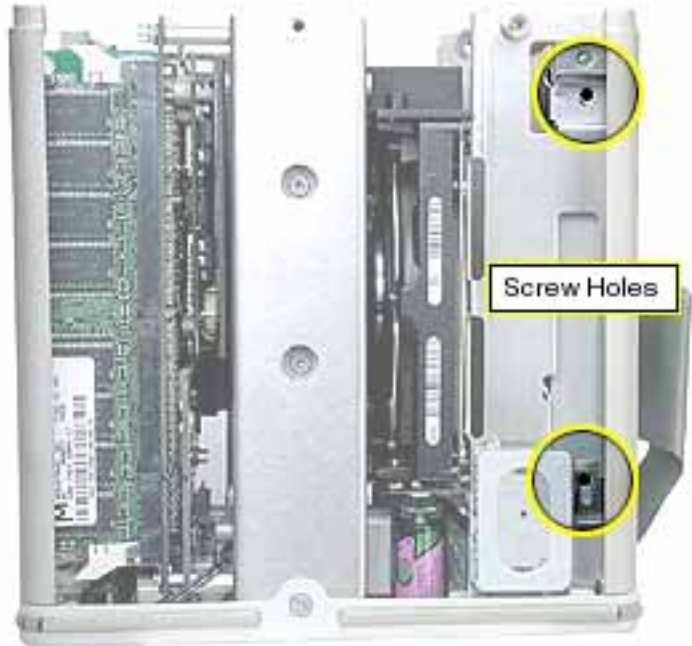

- 5 Install the screws, but do not tighten until all four are in the screw holes. Do not overtighten.
- 6 Close the AirPort Card door and secure the antenna cable (and AirPort Card, if applicable).

- 7 Starting with the two bottom tabs, attach the side panel as shown. Ensure all four tabs engage and no cables get caught.

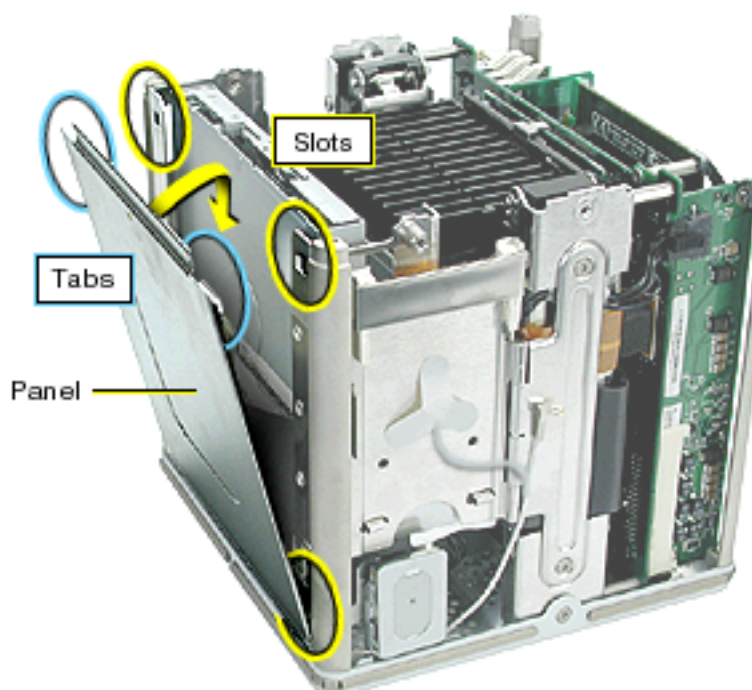

- 8 **Important:** Ensure the side panel tucks into the chassis.

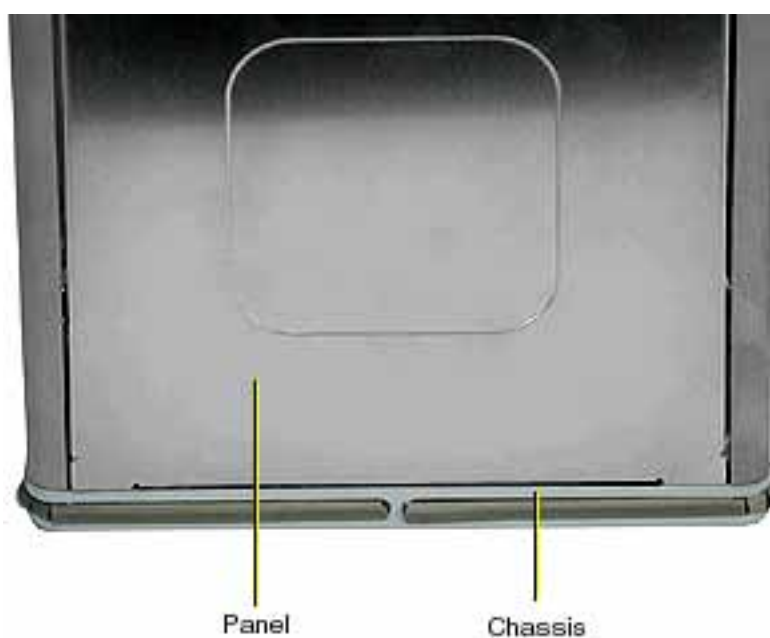

Installing the Top Plate Assembly

- 1 With the top plate assembly in hand, connect the cable from the top plate to the J1 connector on the logic board.

⚠ WARNING: To prevent damage to the power board, ensure the keyed connector fits into the J1 connector as shown.

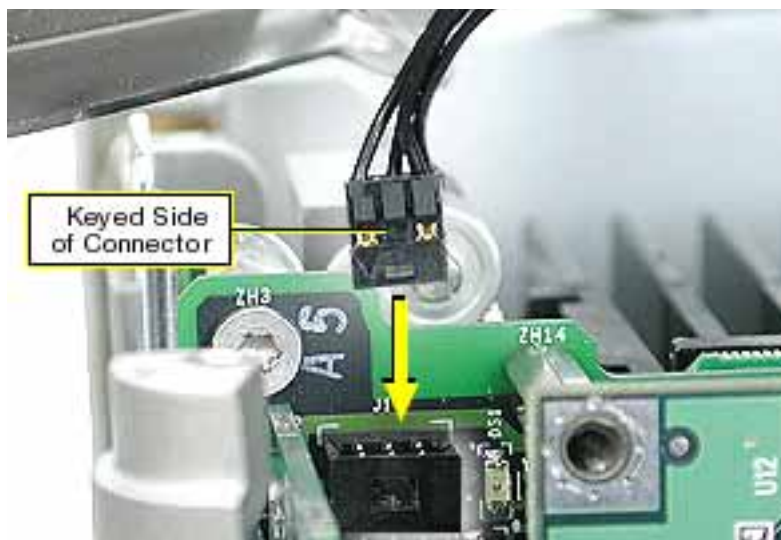

- 2 Position the top plate assembly over the core. Ensure that the four metal tabs align with the four slots in the top plate, and the panel tucks in under the lip of the top plate.

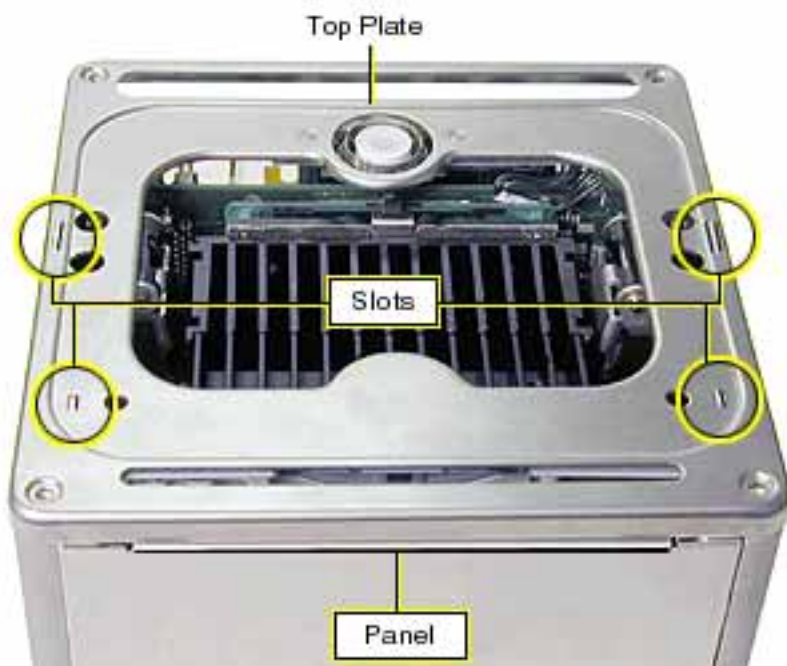

- 3 Starting with the four corner screws, secure the top plate to the core with all eight screws.

Replacing the Computer Core in the Enclosure

- 1 Holding the core by the latch, insert the core into the enclosure. (The core fits only one way, with the ports toward the back of the computer.)
- 2 With a flat hand, press down on the latch until it locks into place. Firmly press the core to ensure it is fully secured within the enclosure.

Important: Do not lift or carry the computer by the core latch. The enclosure could fall off the core and be damaged.

- 3 Turn the computer upright and reconnect all cables.
- 4 Restart the computer.

 **WARNING:** Never turn on the computer unless all of its internal and external parts are in place and it is closed. Operating the computer when it is open or missing parts can damage the computer or cause injury.

 **Apple Computer, Inc.**

© 2001 Apple Computer, Inc. All rights reserved.

Under the copyright laws, this document may not be copied, in whole or in part, without the written consent of Apple.

The Apple logo is a trademark of Apple Computer, Inc., registered in the U.S. and other countries. Use of the “keyboard” Apple logo (Option-Shift-K) for commercial purposes without the prior written consent of Apple may constitute trademark infringement and unfair competition in violation of federal and state laws.





Every effort has been made to ensure that the information in this document is accurate. Apple is not responsible for printing or clerical errors.

Apple Computer, Inc.
1 Infinite Loop
Cupertino, CA 95014-2084
408-996-1010
<http://www.apple.com>

Apple, the Apple logo, Mac, Macintosh, and the Mac logo are trademarks of Apple Computer, Inc., registered in the U.S. and other countries.

Power Mac is a trademark of Apple Computer, Inc.

Power Mac G4 Cube Screw Locator for Screw Kit 076-0874

①		410-1104	(2)	Video Card Fence, Small Phillips Connector Board, to CD/DVD-ROM Drive
②		452-0092	(2) (4)	Video Card Fence, each end CD/DVD-ROM Drive, each side
③		452-0133	(2)	Modem Board
④		452-0073	(6) (3)	Top Plate Assembly Video Card
⑤		452-0132	(2)	Top Plate Assembly, two sides

